



THE  
**ULTIMATE**  
OUTBOARD MOTOR

# 2022 SUZUKI GENUINE MARINE PARTS AND ACCESSORIES



©2021 SUZUKI GENUINE MARINE PARTS AND ACCESSORIES



300

SUZUKI

FOUR

300

SUZUKI

FOURSTROKE



# INDEX

## **OPERATION SYSTEMS (04-47)**

- 04 **SYNCHRO-EYE**
- 06 **SUZUKI PRECISION CONTROL (S.P.C)**
- 16 **MECHANICAL REMOTE CONTROL**
- 20 **COMPONENT OF MECHANICAL REMOTE CONTROL**
- 24 **NEW KEYLESS START SYSTEM**
- 30 **SUZUKI MULTI-FUNCTION GAUGE (SMG4)**
- 38 **SUZUKI DIAGNOSTIC SYSTEM MOBILE**
- 40 **ANALOGUE INSTRUMENT**
- 42 **STEERING**
- 44 **ELECTRICAL PARTS**
- 46 **FUEL SYSTEM**

## **SUZUKI PROPELLERS (48-51)**

- 48 **WATERGRIP**
- 50 **PROPELLER LINE-UP**

## **MAINTAINING YOUR SUZUKI (52-55)**

- 52 **CARE & MAINTENANCE ITEM**
- 54 **MAINTENANCE KITS**

# Integrated Control System

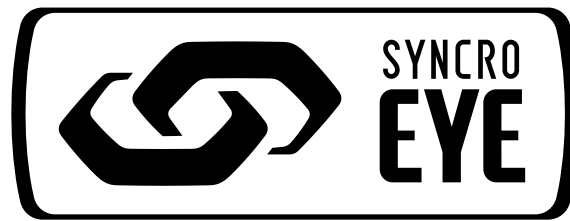

"SYNCRE-EYE" is a comprehensive system Suzuki has developed which "connects" various devices so that they may work together in synchronization. This innovative system will also improve the control technology of the boat by "sensing" various situations surrounding the boat and be compatible with future technology.





OPERATION SYSTEMS

SYNCHRO-EYE



# NEW SUZUKI PRECISION CONTROL (S.P.C)

## New Remote Control Box

- Integrated "SELECT" and "THROTTLE ONLY" switches
- Integrated Emergency switch (Flush Mount only)
- 1 Lever Operation : This switch allows multiple motor operation with just 1 lever(Dual top mount only)



Single Top Mount



Dual Top Mount



Flush Mount

## All New Suzuki Precision Control

Suzuki's best technology lies in the Suzuki Precision Control (S.P.C) for the Drive-By-Wire System. With the S.P.C, a computer electronically sends signals to the engine by wire, eliminating friction and making shifting easier and smoother. The S.P.C also processes and transmits commands in real-time to the actuator. This enables instant, precise throttle response for greater control and accuracy.

This year, we bring the first full model change of the S.P.C system. The new system features:

- Control of up to 6 OBM units.
- Automatic Trim available by using SMD or SMG4.
- All new designs for the Remote Control Box, Switch Panel and Control Panel.

### New Switch Panel

- New Panel types : Horizontal and Separate type panel to suit all helm layout needs
- Mounting bolts are concealed for a smooth, luxurious finish
- Easy start for multi-motor boats : Users can start all motors with 1 button/switch. Motors start in order from port to starboard



\*Emergency switch not needed if using flush mount

### New Control Panel



Find out more!

# COMPONENT PARTS

## 1 R/C BOX BINNACLE MOUNT R/C BOX

## FLUSH MOUNT R/C BOX



**67200-98L00-000**  
for Single Engine



**67200-98L10-000**  
for Dual Engine



**67200-98L20-000**  
for Single Engine

## 2 CONTROL PANEL



**37120-98L00-000**  
for Dual Engine



**37120-98L10-000**  
for Triple Engine



**37120-98L20-000**  
for Quadruple Engine  
PORT



**37120-98L30-000**  
for Quadruple Engine,  
Quintuple Engine  
STBD



**37120-98L40-000**  
for Quintuple Engine  
PORT



**37120-98L50-000**  
for Sextuple Engine  
PORT



**37120-98L60-000**  
for Sextuple Engine  
STBD

## 3 BUZZER

## 4 BOAT CONTROL MODULE

## BCM HOLDER (L) BCM HOLDER (R)

## BCM CUSHION



**38500-93J90-000**



**36770-98L00-000**



**36775-98J00-000**  
(L)

**36776-98J00-000**  
(R)



**33925-98L00-000**



**5** TERMINAL RESISTOR



**33926-98L00-000**

**6** BATTERY LEAD WIRE



**36625-98J10-000**  
2.2 meters

**36625-98J20-000**  
6.1 meters

**7** BCM #1 WIRING HARNESS



**36623-98L00-000**  
for Single Engine

**36623-98L30-000**  
for Dual or Triple Engine

**36623-98L40-000**  
for Quadruple Engine

**8** HARNESS, EMERGENCY SWITCH EXTENSION



**36627-98L10-000**

**9** SIGNAL CONVERTER UNIT



**37140-98L00-000**

**10** DUAL STATION WIRING HARNESS



**36622-98L00-000**

**11** BCM #2 WIRING HARNESS



**36624-98L00-000**  
for Single Engine

**36624-98L10-000**  
for Dual or Triple Engine

**36624-98L20-000**  
for Quadruple Engine

**12** ENGINE WIRING HARNESS



**36621-98L00-000**  
for Dual Engine

**13** MAIN SWITCH PANEL VERTICAL



**37100-98L10-000**  
single ignition with  
Emergency stop switch

MAIN SWITCH PANEL HORIZONTAL



**37100-98L20-000**  
single ignition with  
Emergency stop switch

MAIN SWITCH PANEL



**37100-98L00-000**  
single ignition without  
Emergency stop switch

# COMPONENT PARTS

**13** MAIN SWITCH PANEL  
VERTICAL



**37290-98L10-000**  
single ignition with  
Emergency stop switch

MAIN SWITCH PANEL  
HORIZONTAL



**37290-98L20-000**  
single ignition with  
Emergency stop switch

MAIN SWITCH PANEL  
(KEYLESS START SYSTEM)



**37290-98L00-000**  
single ignition without  
Emergency stop switch

**14** EMERGENCY SWITCH  
PANEL



**37803-98L00-000**

**15** MAIN WIRING HARNESS



**36620-98L00-000**  
6.5 meters for control system

**36620-98L10-000**  
9.5 meters for control system

**16** MAIN WIRING HARNESS  
EXTENSION

**36620-98L20-000**  
2.0 meters for control system

**17** TROLL MODE SWITCH  
PANEL



**37860-98L00-000**

**18** R/C BOX  
HARNESS EXTENSION



**36627-98L00-000**  
1 meter

**19** HARNESS COMP,  
CAN EXT



**36627-98L20-000**  
for triple engine,  
and quadruple engine

# EXTRA OPTION

## COUNTER SELECT CONNECTOR

### 36612-98J20-000

Applicable Model DF150AP/175AP  
DF200AP/250AP/300AP

Converts to counter rotation specification.

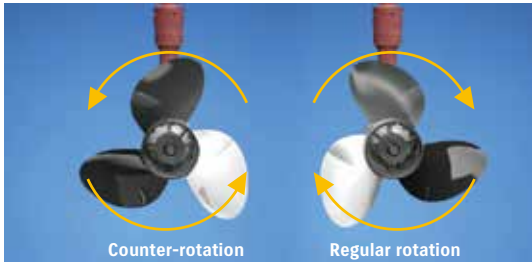

## Suzuki Selective Rotation

In multi-outboard installations on large boats, a counter-rotation outboard is usually paired with a regular rotation model to help keep the boat traveling on an even keel and in a straight line. AP Models are built with special counter-rotating gearing in the lower unit, which causes the prop to rotate in the opposite direction. Suzuki Selective Rotation eliminates the need to purchase a dedicated counter-rotation outboard by using a special switch that turns a regular rotation outboard into a counter-rotation model with a counter-rotational propeller. This industry-first is made possible through a unique design of gears, shaft, and bearings in the lower unit that are designed to which can operate reliably and efficiently in either both regular or counter-rotation directions.

**SUZUKI  
SELECTIVE ROTATION**



# REMOTE-CONTROL KIT

## SINGLE ENGINE

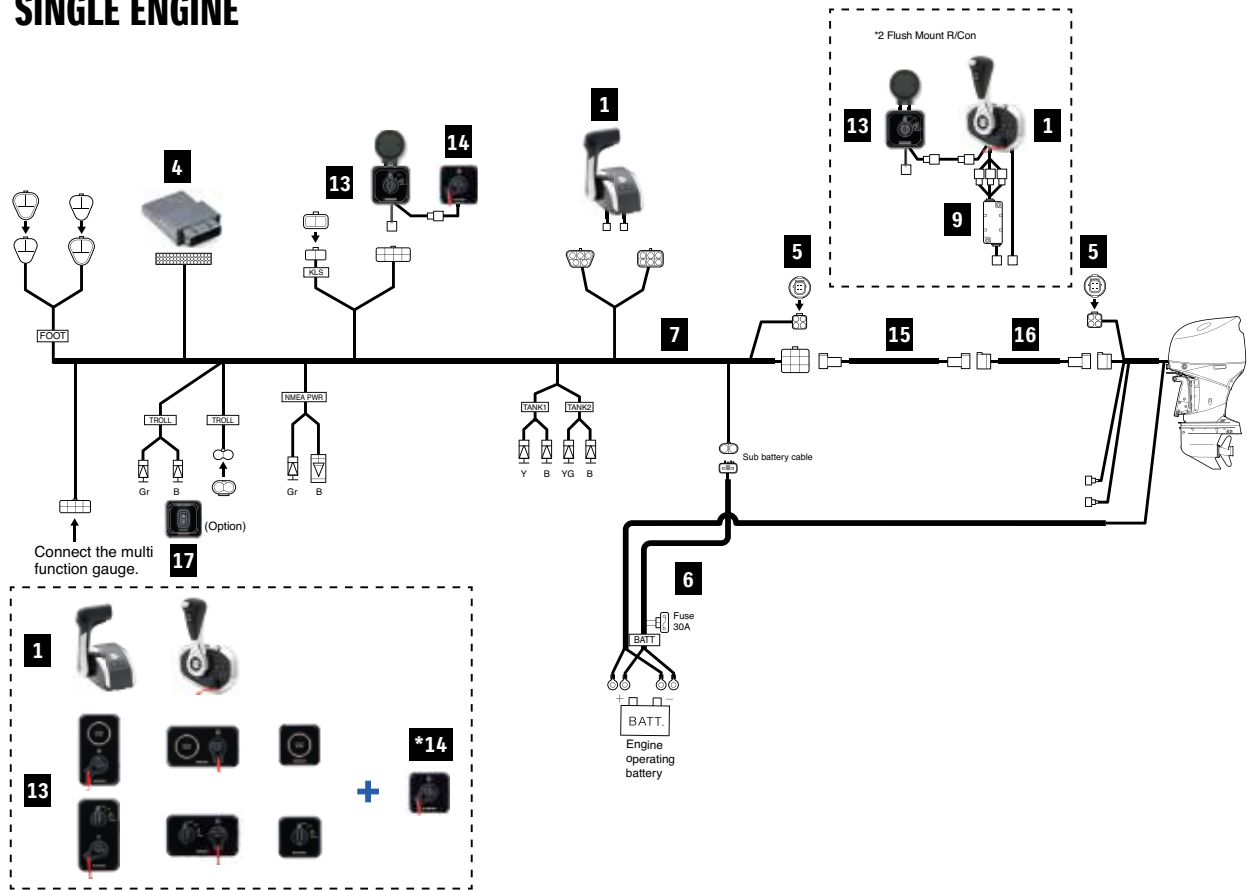

For SINGLE ENGINE (Single Station)				KIT			
	PART NUMBER	PART NAME	LENGTH	BINNACLE-MOUNT		FLUSH-MOUNT	
				1st STATION KIT	2nd STATION KIT	1st STATION KIT	2nd STATION KIT
				67000-98L00-000	67000-98LA0-000	67000-98L10-000	67000-98LB0-000
1	67200-98L00-000	BINNACLE MOUNT R/C BOX		1	1	-	-
	67200-98L20-000	FLUSH MOUNT R/C BOX		-	-	1	1
3	38500-93J90-000	WARNING BUZZER		-	1	-	1
	09407-08401-000	WARNING BUZZER CLAMP		-	1	-	1
4	36770-98L00-000	BOAT CONTROL MODULE		1	1	1	1
	36775-98L00-000	BCM HOLDER (L)		1	1	1	1
	36776-98L00-000	BCM HOLDER (R)		1	1	1	1
	33925-98L00-000	BCM CUSHION		1	1	1	1
5	33926-98L00-000	TERMINAL RESISTOR		2	-	2	-
6	36625-98J10-000	BATTERY-LEAD		1	-	1	-
7	36623-98L00-000	BCM #1 WIRING HARNESS		1	-	1	-
8	36627-98L10-000	HARNESS ASSY,EM SWITCH EXT		-	-	1	1
9	37140-98L00-000	UNIT COMP,SIGNAL CONVERTER		-	-	1	1
10	36622-98L00-000	DUAL-STATION WIRING HARNESS		-	1	-	1
11	36624-98L00-000	BCM #2 WIRING HARNESS		-	1	-	1
-	09403-13402-000	HARNESS CLAMP		10	10	10	10
13	37100-98L00-000	MAIN SWITCH PANEL		Select type	Select type	37100-98L00 or 37290-98L00	37290-98L00
	37100-98L10-000	MAIN SWITCH PANEL VERTICAL					
	37100-98L20-000	MAIN SWITCH PANEL HORIZONTAL					
	37290-98L00-000	MAIN SWITCH PANEL (Keyless)					
	37290-98L10-000	MAIN SWITCH PANEL VERTICAL (Keyless)					
37290-98L20-000	MAIN SWITCH PANEL HORIZONTAL (Keyless)						
14	37803-98L00-000	EMERGENCY SWITCH PANEL		*1	*1		
15	36620-98L00-000	MAIN WIRING HARNESS	6.5m	Select length			
	36620-98L10-000	MAIN WIRING HARNESS EXTENSION	9.5m	Select length			
16	36620-98L20-000	MAIN WIRING HARNESS EXTENSION	2m	Select if necessary			
17	37860-98L00-000	TROLL MODE SWITCH PANEL (optional)		Optional			
18	36627-98L00-000	HARNESS COMP,R/CON EXT				*1	*1

13 to 18 are not included in these kits. Please purchase these items separately.  
 13, 15, 16 : Select appropriate type  
 14 is required when using 37100-98L00-000 or 37290-98L00-000 with BINNACLE-MOUNT CONTROL KIT.  
 17 is optional. Please purchase only if required.  
 18 is required when using FLUSH-MOUNT CONTROL KIT.

# DUAL ENGINE

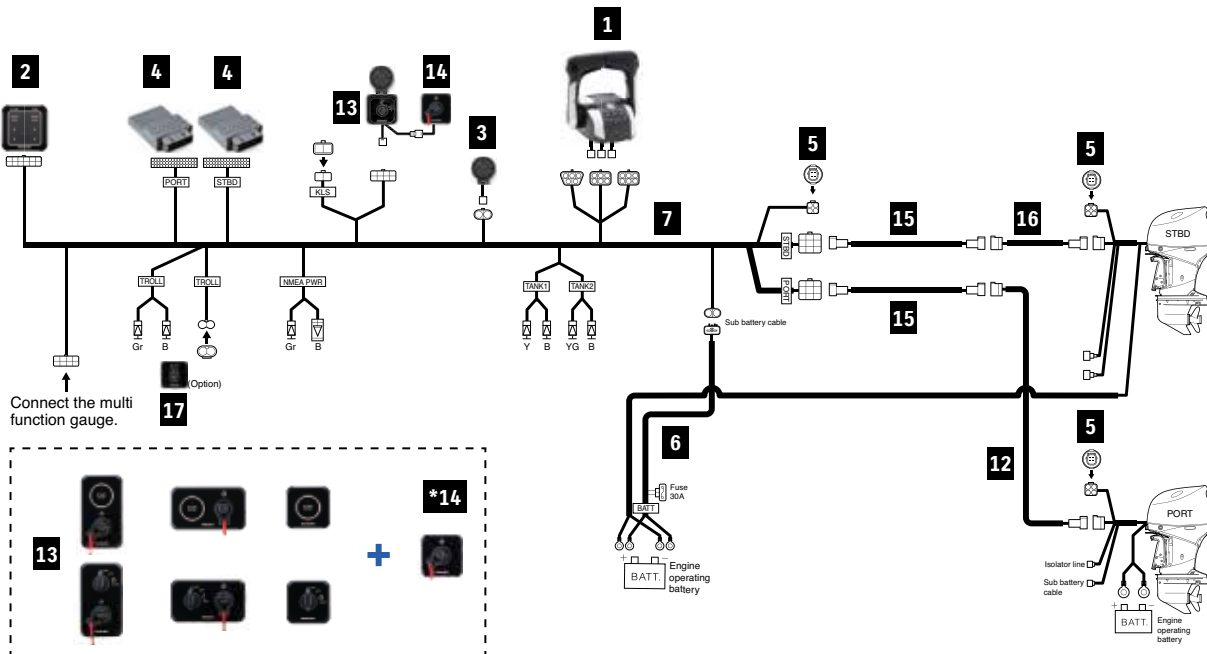

	For DUAL ENGINE			KIT	
	PART NUMBER	PART NAME	LENGTH	1st STATION KIT	2nd STATION KIT
				67000-98L20-000	67000-98LC0-000
<b>1</b>	67200-98L10-000	BINNACLE MOUNT R/C BOX		1	1
<b>2</b>	37120-98L00-000	CONTROL PANEL		1	1
	38500-93J90-000	WARNING BUZZER		1	2
<b>3</b>	09407-08401-000	WARNING BUZZER CLAMP		1	2
	36770-98L00-000	BOAT CONTROL MODULE		2	2
<b>4</b>	36775-98L00-000	BCM HOLDER (L)		2	2
	36776-98L00-000	BCM HOLDER (R)		2	2
	33925-98L00-000	BCM CUSHION		2	2
<b>5</b>	33926-98L00-000	TERMINAL RESISTOR		3	-
<b>6</b>	36625-98J10-000	BATTERY-LEAD		1	-
<b>7</b>	36623-98L30-000	BCM #1 WIRING HARNESS		1	-
<b>10</b>	36622-98L00-000	DUAL-STATION WIRING HARNESS		-	1
<b>11</b>	36624-98L10-000	BCM #2 WIRING HARNESS		-	1
<b>12</b>	36621-98L00-000	ENGINE WIRING HARNESS		1	-
-	09403-13402-000	HARNESS CLAMP		15	10
-	36612-98J20-000	CONNECTOR, COUNTER SELECT		1	-
<b>13</b>	37100-98L00-000	MAIN SWITCH PANEL		Select type	Select type
	37100-98L10-000	MAIN SWITCH PANEL VERTICAL			
	37100-98L20-000	MAIN SWITCH PANEL HORIZONTAL			
	37290-98L00-000	MAIN SWITCH PANEL (Keyless)			
	37290-98L10-000	MAIN SWITCH PANEL VERTICAL (Keyless)			
	37290-98L20-000	MAIN SWITCH PANEL HORIZONTAL (Keyless)			
<b>14</b>	37803-98L00-000	EMERGENCY SWITCH PANEL		*1	*1
<b>15</b>	36620-98L00-000	MAIN WIRING HARNESS	6.5m	Select length	
	36620-98L10-000		9.5m		
<b>16</b>	36620-98L20-000	MAIN WIRING HARNESS EXTENSION	2m	Select if necessary	
<b>17</b>	37860-98L00-000	TROLL MODE SWITCH PANEL (optional)		Optional	
<b>18</b>	36627-98L00-000	HARNESS COMP/R/CON EXT		Select if necessary	

13 to 18 are not included in these kits. Please purchase these items separately.  
 13, 15, 16 : Select appropriate type  
 14 is required when using 37100-98L00-000 or 37290-98L00-000 with BINNACLE-MOUNT CONTROL KIT.  
 17 is optional. Please purchase only if required.

# REMOTE-CONTROL KIT

## TRIPLE ENGINE

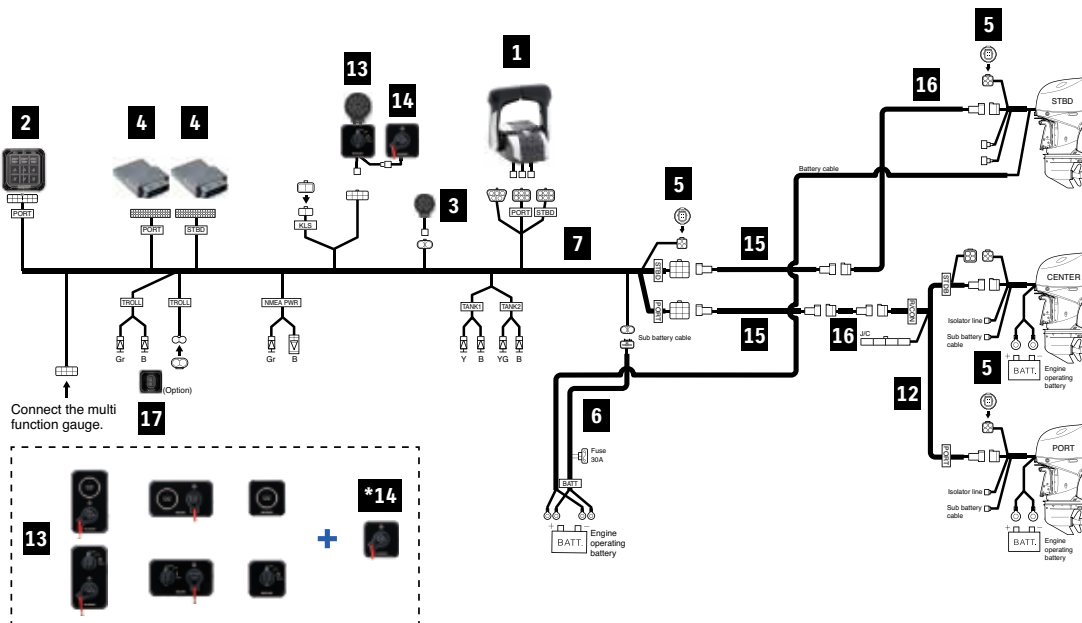

For TRIPLE ENGINE				KIT	
PART NUMBER	PART NAME	LENGTH	1st STATION KIT	2nd STATION KIT	
			67000-98L30-000	67000-98LD0-000	
1	67200-98L10-000	BINNACLE MOUNT R/C BOX	1	1	
2	37120-98L10-000	CONTROL PANEL	1	1	
3	38500-93J90-000	WARNING BUZZER	1	2	
	09407-08401-000	WARNING BUZZER CLAMP	1	2	
4	36770-98L00-000	BOAT CONTROL MODULE	2	2	
	36775-98L00-000	BCM HOLDER (L)	2	2	
	36776-98L00-000	BCM HOLDER (R)	2	2	
	33925-98L00-000	BCM CUSHION	2	2	
5	33926-98L00-000	TERMINAL RESISTOR	3	-	
6	36625-98J10-000	BATTERY-LEAD	1	-	
7	36623-98L30-000	BCM #1 WIRING HARNESS	1	-	
10	36622-98L00-000	DUAL-STATION WIRING HARNESS	-	1	
11	36624-98L10-000	BCM #2 WIRING HARNESS	-	1	
12	36621-98L00-000	ENGINE WIRING HARNESS	1	-	
-	09403-13402-000	HARNESS CLAMP	18	10	
-	36612-98J20-000	CONNECTOR, COUNTER SELECT	1	-	
13	37100-98L00-000	MAIN SWITCH PANEL	Select type	Select type	
	37100-98L10-000	MAIN SWITCH PANEL VERTICAL			
	37100-98L20-000	MAIN SWITCH PANEL HORIZONTAL			
	37290-98L00-000	MAIN SWITCH PANEL (Keyless)			
	37290-98L10-000	MAIN SWITCH PANEL VERTICAL (Keyless)			
	37290-98L20-000	MAIN SWITCH PANEL HORIZONTAL (Keyless)			
14	37803-98L00-000	EMERGENCY SWITCH PANEL	*1	*1	
15	36620-98L00-000	MAIN WIRING HARNESS	6.5m	Select length	
	36620-98L10-000	MAIN WIRING HARNESS EXTENSION	9.5m		
16	36620-98L20-000	MAIN WIRING HARNESS EXTENSION	2m	Select if necessary	
17	37860-98L00-000	TROLL MODE SWITCH PANEL		Optional	
18	36627-98L00-000	HARNESS COMP, R/CON EXT		Select if necessary	
19	36627-98L20-000	HARNESS COMP, CAN EXT		Select if necessary	

13 to 19 are not included in these kits. Please purchase these items separately.  
 13, 15, 16 : Select appropriate type  
 14 is required when using 37100-98L00-000 or 37290-98L00-000 with BINNACLE-MOUNT CONTROL KIT.  
 17 is optional. Please purchase only if required.

# QUADRUPLE ENGINE

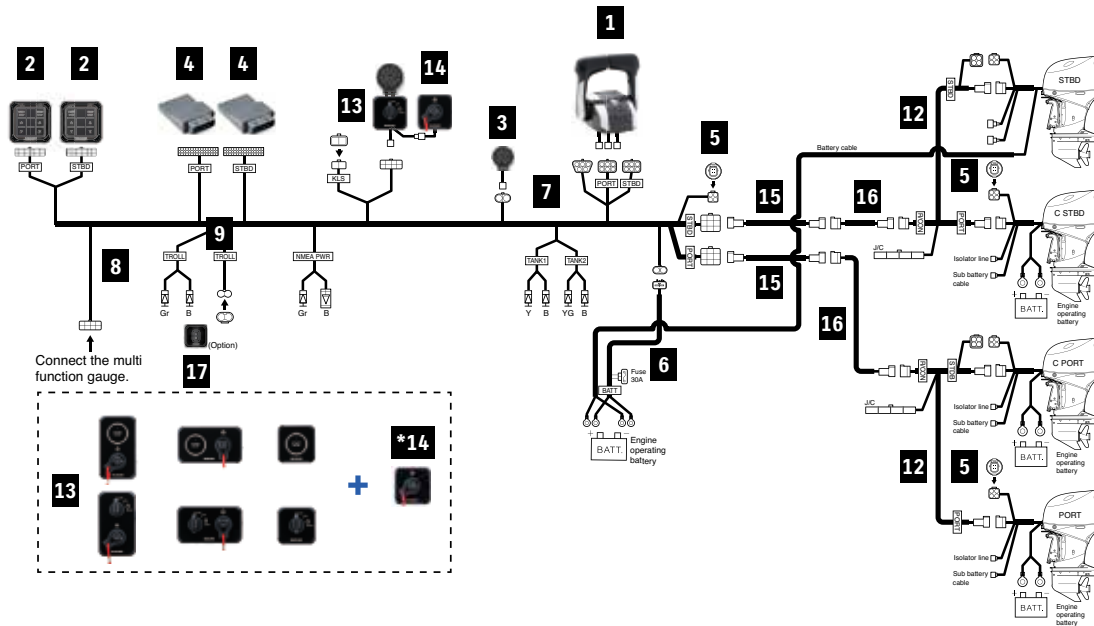

For QUADRUPLE ENGINE				KIT	
	PART NUMBER	PART NAME	LENGTH	1st STATION KIT	2nd STATION KIT
				67000-98L40-000	67000-98LE0-000
1	67200-98L10-000	BINNACLE MOUNT R/C BOX		1	1
2	37120-98L20-000	CONTROL PANEL PORT		1	1
	37120-98L30-000	CONTROL PANEL STBD		1	1
3	38500-93J90-000	WARNING BUZZER		1	2
	09407-08401-000	WARNING BUZZER CLAMP		1	2
4	36770-98L00-000	BOAT CONTROL MODULE		2	2
	36775-98L00-000	BCM HOLDER (L)		2	2
	36776-98L00-000	BCM HOLDER (R)		2	2
	33925-98L00-000	BCM CUSHION		2	2
5	33926-98L00-000	TERMINAL RESISTOR		3	-
6	36625-98J10-000	BATTERY-LEAD		1	-
7	36623-98L40-000	BCM #1 WIRING HARNESS		1	-
10	36622-98L00-000	DUAL-STATION WIRING HARNESS		-	1
11	36624-98L20-000	BCM #2 WIRING HARNESS		-	1
12	36621-98L00-000	ENGINE WIRING HARNESS		2	-
-	09403-13402-000	HARNESS CLAMP		20	15
-	36612-98J20-000	CONNECTOR, COUNTER SELECT		2	-
13	37100-98L00-000	MAIN SWITCH PANEL		Select type	
	37100-98L10-000	MAIN SWITCH PANEL VERTICAL			
	37100-98L20-000	MAIN SWITCH PANEL HORIZONTAL			
	37290-98L00-000	MAIN SWITCH PANEL (Keyless)			
	37290-98L10-000	MAIN SWITCH PANEL VERTICAL (Keyless)			Select type
	37290-98L20-000	MAIN SWITCH PANEL HORIZONTAL (Keyless)			
14	37803-98L00-000	EMERGENCY SWITCH PANEL		*1	*1
15	36620-98L00-000	MAIN WIRING HARNESS	6.5m	Select length	
	36620-98L10-000	MAIN WIRING HARNESS	9.5m		
16	36620-98L20-000	MAIN WIRING HARNESS EXTENSION	2m	Select if necessary	
17	37860-98L00-000	TROLL MODE SWITCH PANEL		Optional	
18	36627-98L00-000	HARNESS COMP,R/CON EXT		Select if necessary	
19	36627-98L20-000	HARNESS COMP,CAN EXT		Select if necessary	

13 to 19 are not included in these kits. Please purchase these items separately.  
 13, 15, 16 : Select appropriate type  
 14 is required when using 37100-98L00-000 or 37290-98L00-000 with BINNACLE-MOUNT CONTROL KIT.  
 17 is optional. Please purchase only if required.

# MECHANICAL REMOTE CONTROL





# REMOTE-CONTROL KIT

Mechanical Remote Control model users now have the option of choosing to use the new switch panel.



To use the previous panel, please refer to the installation manual for the wiring diagram.

# SINGLE ENGINE

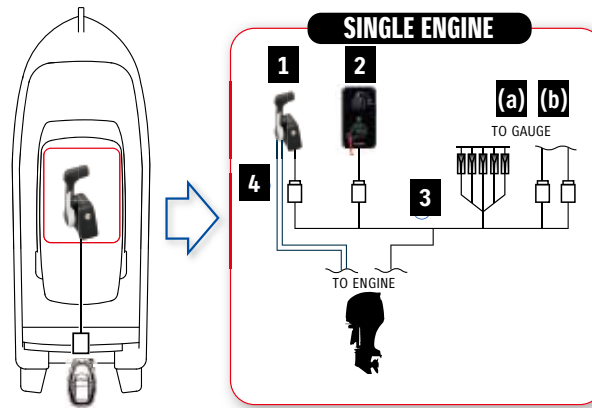

## For SINGLE ENGINE (Single Station)

	PART NUMBER	PART NAME	LENGTH	BINNACLE-MOUNT	FLUSH-MOUNT	SIDE-MOUNT
1	67200-88L01-000	BINNACLE MOUNT R/C BOX		1	-	-
	67200-93J34-000	FLUSH MOUNT R/C BOX		-	1	-
	67200-93J61-000	SIDE MOUNT R/C BOX		-	-	1
2	37100-98L00-000	MAIN SWITCH PANEL IG SWITCH ONLY		1 (Select type)		
	37100-98L10-000	MAIN SWITCH PANEL VERTICAL				
	37100-98L20-000	MAIN SWITCH PANEL HORIZONTAL				
	37803-98L00-000	PANEL ASSY, EMERGENCY SWITCH				
3	36620-93J70-000	MAIN WIRING HARNESS	6.5m	1 (Select length)		
	36620-93J80-000		5m			
	36620-93J90-000		8m			
4	67320-93J00-000	R/C CABLE (ORT THROTTLE AND SHIFT CABLES)	2.4m	2 (Select length)		
	67320-93J10-000		3m			
	67320-93J20-000		3.6m			
	67320-93J30-000		4.2m			
	67320-93J40-000		4.8m			
	67320-93J50-000		5.4m			
	67320-93J60-000		6.1m			
	67320-93J70-000		6.7m			
67320-93J80-000	7.3m					
-	36620-93J11-000	MAIN WIRING HARNESS EXTENSION	2m	Select if necessary		
	36620-93J41-000		3m			

\*Only needed if using 37100-98L00

## For KEYLESS START SYSTEM

### For SINGLE ENGINE

	PART NUMBER	PART NAME	LENGTH	KIT					Required SINGLE STATION
				67000-88L43-000 BINNACLE-MOUNT CONTROL KIT	67000-88L65-000 BINNACLE-MOUNT CONTROL KIT	67000-93JF4-000 FLUSH-MOUNT CONTROL KIT	67000-93JK6-000 FLUSH-MOUNT CONTROL KIT	67000-93JM2-000 SIDE-MOUNT CONTROL KIT	
1	67200-88L01-000	BINNACLE MOUNT R/C BOX		1	1	-	-	-	1
	67200-93J34-000	FLUSH MOUNT R/C BOX		-	-	1	1	-	
	67200-96L11-000	SIDE MOUNT R/C BOX		-	-	-	-	1	
2	37100-96L12-000	SINGLE IGNITION WITH E/S SWITCH		1	1	1	1	*A	1
3	36620-93J70-000	MAIN WIRING HARNESS	6.5m	-	1	-	1	1	1
	36620-93J80-000		5m	-	-	-	-		
	36620-93J90-000		8m	-	-	-	-		
(a)	34200-93J14-000	TACHOMETER (WHITE)		-	1	-	1	1	
(b)	34800-93J13-000	TRIM GAUGE (WHITE)		-	1	-	1	1	
4	67320-93J00-000	R/C CABLE (ORT THROTTLE AND SHIFT CABLES)	2.4m	**Select length					2
	67320-93J10-000		3m						
	67320-93J20-000		3.6m						
	67320-93J30-000		4.2m						
	67320-93J40-000		4.8m						
	67320-93J50-000		5.4m						
	67320-93J60-000		6.1m						
	67320-93J70-000		6.7m						
67320-93J80-000	7.3m								
-	36620-93J11-000	MAIN WIRING HARNESS EXTENSION	2m	**Select if necessary					
	36620-93J41-000		3m						

■ \*\*Not included in kit

■ \*A The side mount control box is equipped with ignition switch, emergency switch and warning buzzer with clamp.

## DUAL ENGINE

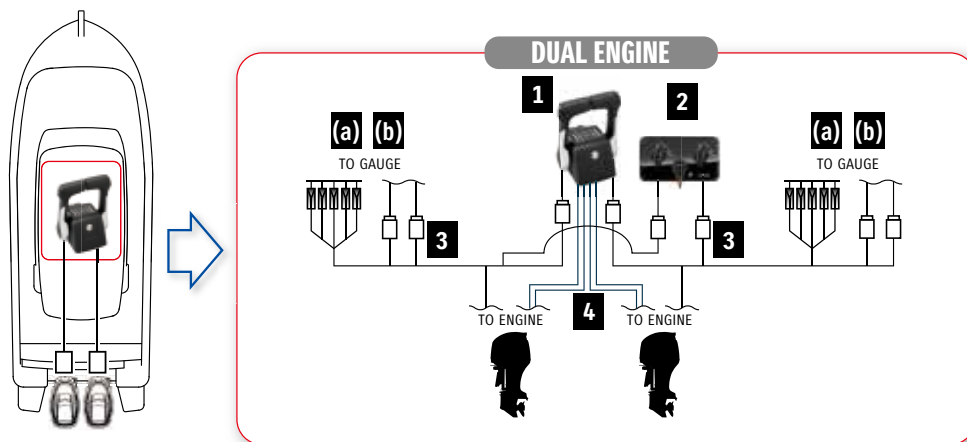

For DUAL ENGINE					Required Qty
	PART NUMBER	PART NAME	LENGTH	Qty	Single Station
1	67200-88L11-000	BINNACLE MOUNT R/C BOX		1	1
2	37100-98L00-000	MAIN SWITCH PANEL IG SWITCH ONLY		2	Select -98L00 OR -98L30
	37100-98L30-000	DUAL IGNITION WITH E/S SWITCH		1	
3	37803-98L00-000	PANEL ASSY, EMERGENCY SWITCH		*1	*1
	36620-93J70-000	MAIN WIRING HARNESS	6.5m	(Select length)	2
	36620-93J80-000		5m		
	36620-93J90-000		8m		
4	67320-93J00-000	R/C CABLE (ORT THROTTLE AND SHIFT CABLES)	2.4m	(Select length)	4
	67320-93J10-000		3m		
	67320-93J20-000		3.6m		
	67320-93J30-000		4.2m		
	67320-93J40-000		4.8m		
	67320-93J50-000		5.4m		
	67320-93J60-000		6.1m		
	67320-93J70-000		6.7m		
67320-93J80-000	7.3m				
-	36620-93J11-000	MAIN WIRING HARNESS EXTENSION	2m	Select if necessary	-
	36620-93J41-000		3m		

\*Only needed if using 37100-98L00

## For KEYLESS START SYSTEM

For DUAL ENGINE				KIT		Required
	PART NUMBER	PART NAME	LENGTH	67000-88L53-000 BINNACLE-MOUNT CONTROL KIT	67000-88L75-000 BINNACLE-MOUNT CONTROL KIT	SINGLE STATION
1	67200-88L11-000	BINNACLE MOUNT R/C BOX		1	1	1
2	37100-96L22-000	DUAL IGNITION WITH E/S SWITCH		1	1	1
	36620-93J70-000					
3	36620-93J80-000 36620-93J90-000	MAIN WIRING HARNESS	6.5m	-	2	2
			5m	-	-	
			8m	-	-	
(a)	34200-93J14-000	TACHOMETER (WHITE)		-	2	
(b)	34800-93J13-000	TRIM GAUGE (WHITE)		-	2	
4	67320-93J00-000	R/C CABLE (ORT THROTTLE AND SHIFT CABLES)	2.4m	**Select length		4
	67320-93J10-000		3m			
	67320-93J20-000		3.6m			
	67320-93J30-000		4.2m			
	67320-93J40-000		4.8m			
	67320-93J50-000		5.4m			
	67320-93J60-000		6.1m			
	67320-93J70-000		6.7m			
67320-93J80-000	7.3m					
-	36620-93J11-000	MAIN WIRING HARNESS EXTENSION	2m	**Select if necessary	1	
	36620-93J41-000		3m			
-	36621-96L00-000	HARNSS ASSY, DUAL KLS ENG		1	1	
-	36663-96L10-000	WIRE COMP, KLS CAN EXT		1	1	
-	36664-96L00-000	HARNSS ASSY, KLS CAN		1	1	

■ \*\*Not included in kit

# COMPONENT OF MECHANICAL REMOTE CONTROL

1

R/C BOX  
BINNACLE MOUNT R/C BOX

BINNACLE MOUNT R/C BOX DUAL

FLUSH MOUNT R/C BOX



**67200-88L01-000**

for Single Engine

Applicable Model DF8A-250



**67200-88L11-000**

for Dual Engine

Applicable Model DF70A-250



**67200-93J34-000**

for Single Engine

Applicable Model DF8A-250

SIDE MOUNT REMOTE CONTROL BOX



**67200-91J31-000**

for Single Engine, without IGN SW

Applicable Model DF4A-6A

**67200-94J40-000**

for Single Engine. With warning buzzer with PTT switch

Applicable Model DF8A-30A

**67200-93J70-000**

for Single Engine. With PTT switch

Applicable Model DF9.9B-250

**67200-96L11-000**

for Single Engine. With PTT switch for Keyless Start System

Applicable Model DF70A-150/175/200A

2

IGNITION SWITCH PANEL



**37100-98L10-000**

Single ignition with  
Emergency stop switch

Applicable Model DF9.9B-250



**37100-98L20-000**

Single ignition with  
Emergency stop switch

Applicable Model DF9.9B-250



**37100-98L30-000**

Dual ignition with  
Emergency stop switch

Applicable Model DF9.9B-250



**37100-98L00-000**

Single ignition

Applicable Model DF9.9B-250

**3** MAIN WIRING HARNESS

MAIN WIRING HARNESS  
EXTENSION



If using the Keyless start system, please use the previous harness and panels. Please refer to the installation manual for details.

**36620-93J70-000**  
6.5 meters for Control system  
Applicable Model DF9.9B/20A/40A-250

**36620-89L00-000**  
6.5 meters for Control system  
Applicable Model DF9.9B/15A/20A

**36620-93J11-000**  
2.0 meters for Control system  
Applicable Model DF9.9B-250

**36620-93J80-000**  
5.0 meters for Control system  
Applicable Model DF40A-250

**36620-94L01-000**  
5.0 meters for Control system  
Applicable Model DF25A/30A

**36620-93J41-000**  
3.0 meters for Control system  
Applicable Model DF9.9B-250

**36620-93J90-000**  
8.0 meters for Control system  
Applicable Model DF40A-250

**4** REMOTE-CONTROL CABLE (ORT THROTTLE AND SHIFT CABLES)



**67320-93J00-000**  
8 feet 2.44 meters  
Applicable Model DF4A-250

**67320-93J50-000**  
18 feet 5.49 meters  
Applicable Model DF4A-250

**67320-93J10-000**  
10 feet 3.05 meters  
Applicable Model DF4A-250

**67320-93J60-000**  
20 feet 6.10 meters  
Applicable Model DF4A-250

**67320-93J20-000**  
12 feet 3.66 meters  
Applicable Model DF4A-250

**67320-93J70-000**  
22 feet 6.71 meters  
Applicable Model DF4A-250

**67320-93J30-000**  
14 feet 4.27 meters  
Applicable Model DF4A-250

**67320-93J80-000**  
24 feet 7.32 meters  
Applicable Model DF4A-250

**67320-93J40-000**  
16 feet 4.88 meters  
Applicable Model DF4A-250

**5** SPACER KIT for REMOTE CONTROL BOX

**6** BATTERY LEAD



**67500-88L00-000**  
for Single Binnacle-mount type  
Applicable Model DF8A-250



**67500-88L10-000**  
for Dual Binnacle-mount type  
Applicable Model DF70A-250



**36625-93J10-000**  
6.7 meters  
Applicable Model DF100A-200A/200-250

**36625-93J01-000**  
3.9 meters  
Applicable Model DF100A-200A/200-250

## 7 REMOTE-CONTROL ATTACHING KIT

Converts ME model to REMOTE-CONTROL model.



### 67101-97L00-000

Applicable Model DF4A-6A

### 67130-89L22-000

Applicable Model DF9.9B/15A/20A

### 67130-94L03-000

Applicable Model DF25A/30A

### 67130-94L13-000

Applicable Model DF25ATH/30ATH

### 67130-99J02-000

CLAMP BRACKET SET (41100-99J00-0EP) is required for installing 67130-99J02-000.

Applicable Model DF8A/9.9A

## 8 TWIN REMOTE-CONTROL ATTACHMENT KIT



### 67140-95601-000

Applicable Model DF9.9B-30A/100A-250

## CLAMP BRACKET SET

### 41100-99JL0-YAY

Applicable Model DF8A/9.9A

## 9 EMERGENCY SWITCH PANEL



### 37803-98L00-000

Applicable Model DF9.9B-350A

## 10 PTT SWITCH PANEL



### 37805-88L00-000

Applicable Model DF40A-250

## (a) TACHOMETER



### 34200-93J14-000

FACE : WHITE

## (b) TRIM GAUGE



### 34800-93J13-000

FACE : WHITE

# EXTRA OPTIONS

## TROLL MODE SWITCH PANEL



**37860-98L00-000**

Applicable Model DF40A-200A/  
150AP-300AP/  
300B/325A/350A

Activates SUZUKI Troll Mode System and controls RPM from idling engine speed up to 1200rpm at every 50rpm.



## SUZUKI TROLL MODE SYSTEM

### Troll Mode Switch:

An option on for Remote Control models from DF40A and over, this system allows the user to adjust engine speed in 50rpm increments, giving highly precise control at low revs. With its own tachometer and control switch, it works alongside our multi-function gauges and analogue gauges.

(Tiller Handle Models from DF40A and over have Suzuki Troll Mode System as standard equipment)

\*Not Applicable for DF250/225/200, DF250W, DF150W, DF90AWQH

## RIGGING TUBE



**990C0-20010-000**

Applicable Model DF70A-DF350A

\*Connect to the hose adapter equipped on the engine



# NEW KEYLESS START SYSTEM



## HIGH SECURITY

- The Suzuki Keyless Start System features an immobilizer function for added peace of mind. IC access codes installed in the key fob and engine must match for the engine to start, preventing any wrong key from starting the engine. It also means the engine will not start on any other boat, discouraging theft of the engine as well.

## EASY OPERATION

- The key fob is easy to carry and one is all you need to enjoy stress-free starts for greater boating pleasure. The System requires no mechanical key, so the key fob remains safely in your pocket. It is also waterproof and floats in case it accidentally falls into the water.  
2 key fobs are included as standard per system. Dealers can program up to 4 additional fobs to allow multiple users (total 6 fobs per boat)

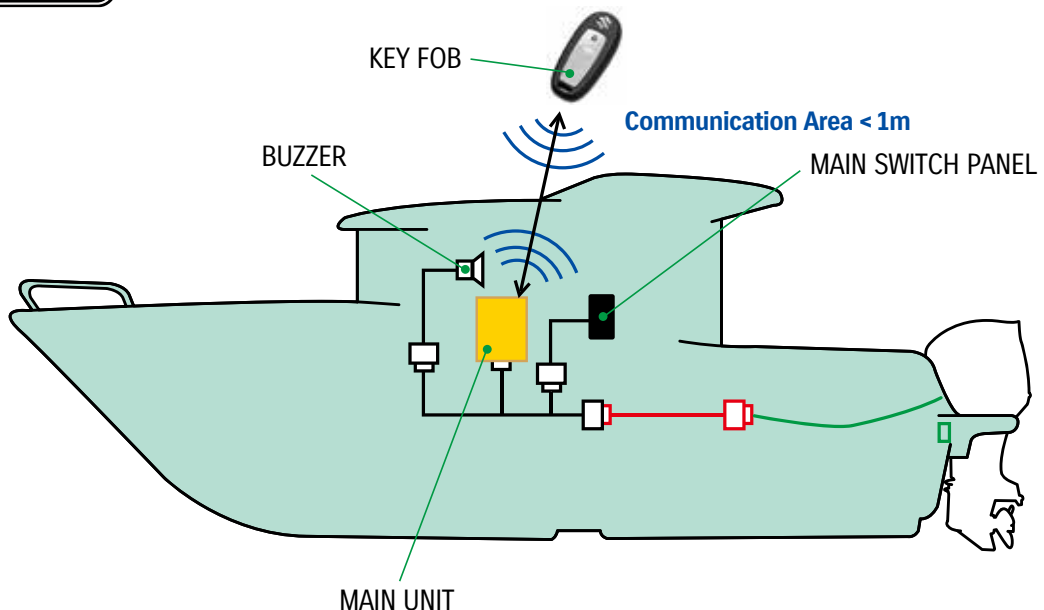

Find out more by watching our videos



## NEW FEATURES

The new Keyless Start System introduces new features for better convenience of both users and dealers, while still providing high security

### New Design

New panel design in sleek black. Addition of Horizontal-type and Separate-type panels.

### One-push start/stop for multiple engines

All engines start in order with just one push (max 6 engines). No need to push the button multiple times.



### Easy Setup and Passcode entry (with SMG4 or SMD)

The new system has a menu selection for easy key fob registration. Also in case of emergency, users can start the engine by directly inputting the passcode into SMG4 or SMD.



# INSTALLATION DIAGRAM

## KEYLESS START SYSTEM for S.P.C

\*SMG4 or SMD is required to use

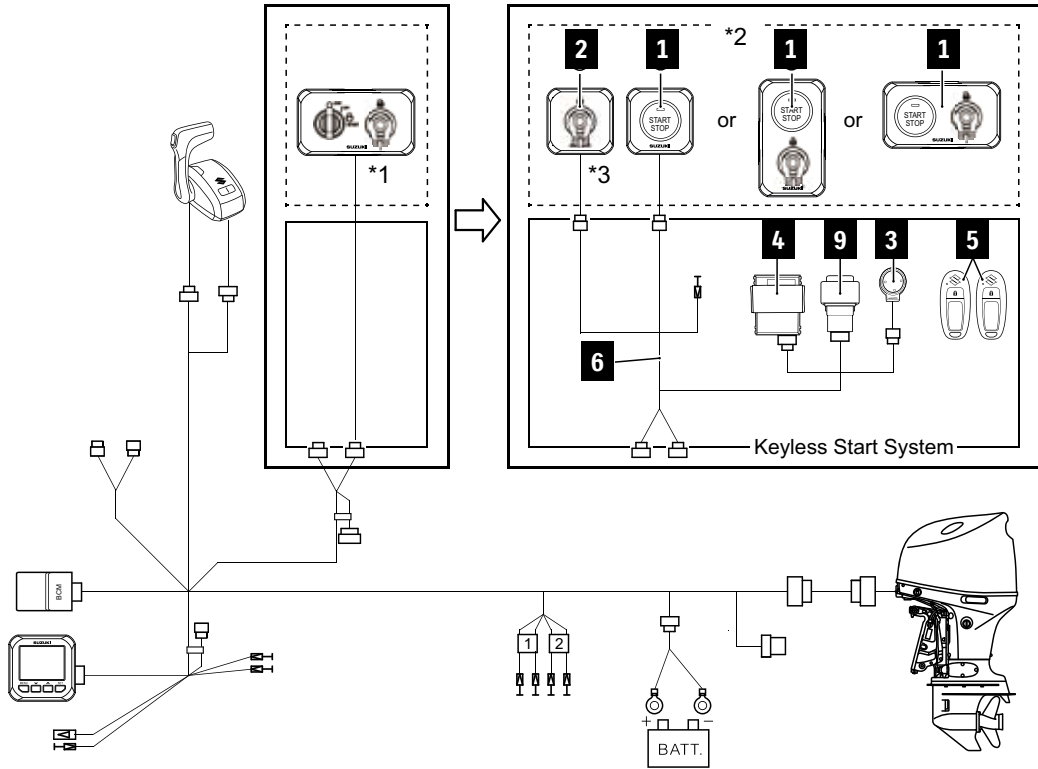

For S.P.C				KIT		Total Required Quantity			
				CONTROLLER SET		SINGLE	DUAL	TRIPLE	QUAD
PART NUMBER	PART NAME	LENGTH	37105-98L01 (433 MHz)	37105-98L10 (315 MHz)					
37290-98L00-000	MAIN SWITCH PANEL	-	-	-	1	1	1	1	
<b>1</b> 37290-98L10-000	MAIN SWITCH PANEL VERTICAL	-	-	-	1	1	1	1	
37290-98L20-000	MAIN SWITCH PANEL HORIZONTAL	-	-	-	1	1	1	1	
<b>2</b> 37803-98L00-000	EMERGENCY SWITCH PANEL	-	-	-	(1)	(1)	(1)	(1)	
<b>3</b> 38500-93J90-000	BUZZER	-	1	1	1	1	1	1	
37171-98L01-000	KEYLESS CONTROL UNIT	-	1	1	1	1	1	1	
37171-98L10-000		-	1	1	1	1	1	1	
37172-96L03-000	KEY FOB	-	2	2	2	2	2	2	
37172-96L11-000		-	2	2	2	2	2	2	
<b>6</b> 36623-98LA0-000	KEYLESS CONTROL HARNESS	-	1	1	1	1	1	1	
<b>9</b> 38860-96L01-000	RELAY ASSY, KLS	-	1	1	1	1	1	1	
<b>10</b> 37173-96L10-000	HOLDER, KLS PARTS	-	1	1	1	1	1	1	
<b>11</b> 32980-38F00-000	HOLDER	-	1	1	1	1	1	1	
<b>12</b> 32851-93J00-000	CUSHION	-	1	1	1	1	1	1	
- 09407-14407-000	CLAMP, KLS HARNESS	-	1	1	1	1	1	1	
- 37117-96L00-000	DECAL, KLS	-	2	2	-	-	-	-	

■ \*( )part is used when using 37290-98L00-000.

# COMPONENT PARTS

- 1** MAIN SWITCH PANEL VERTICAL
- MAIN SWITCH PANEL HORIZONTAL
- MAIN SWITCH PANEL HORIZ
- 2** EMERGENCY SWITCH PANEL



- 3** BUZZER
- 4** KEYLESS CONTROL UNIT
- 5** KEY FOB
- 6** KEYLESS CONTROL HARNESS



- 9** KEYLESS RELAY ASSY
- 10** KEYLESS PARTS HOLDER
- 11** HOLDER
- 12** CUSHION



	PART NUMBER	PART NAME	LENGTH	NOTE
<b>1</b>	37290-98L00-000	MAIN SWITCH PANEL	-	
	37290-98L10-000	MAIN SWITCH PANEL VERTICAL	-	
	37290-98L20-000	MAIN SWITCH PANEL HORIZONTAL	-	
<b>2</b>	37803-98L00-000	EMERGENCY SWITCH PANEL	-	Used when using 37290-98L00-000
<b>3</b>	38500-93J90-000	BUZZER	-	
<b>4</b>	37171-98L01-000	KEYLESS CONTROL UNIT	-	433MHz
	37171-98L10-000		-	315MHz
<b>5</b>	37172-96L03-000	KEY FOB	-	433MHz
	37172-96L11-000		-	315MHz
<b>6</b>	36623-98LA0-000	KEYLESS CONTROL HARNESS	-	
<b>9</b>	38860-96L01-000	RELAY ASSY, KLS	-	
<b>10</b>	37173-96L10-000	HOLDER, KLS PARTS	-	
<b>11</b>	32980-38F00-000	HOLDER	-	
<b>12</b>	32851-93J00-000	CUSHION	-	

# INSTALLATION DIAGRAM

## KEYLESS START SYSTEM for MECHANICAL REMOTE CONTROL

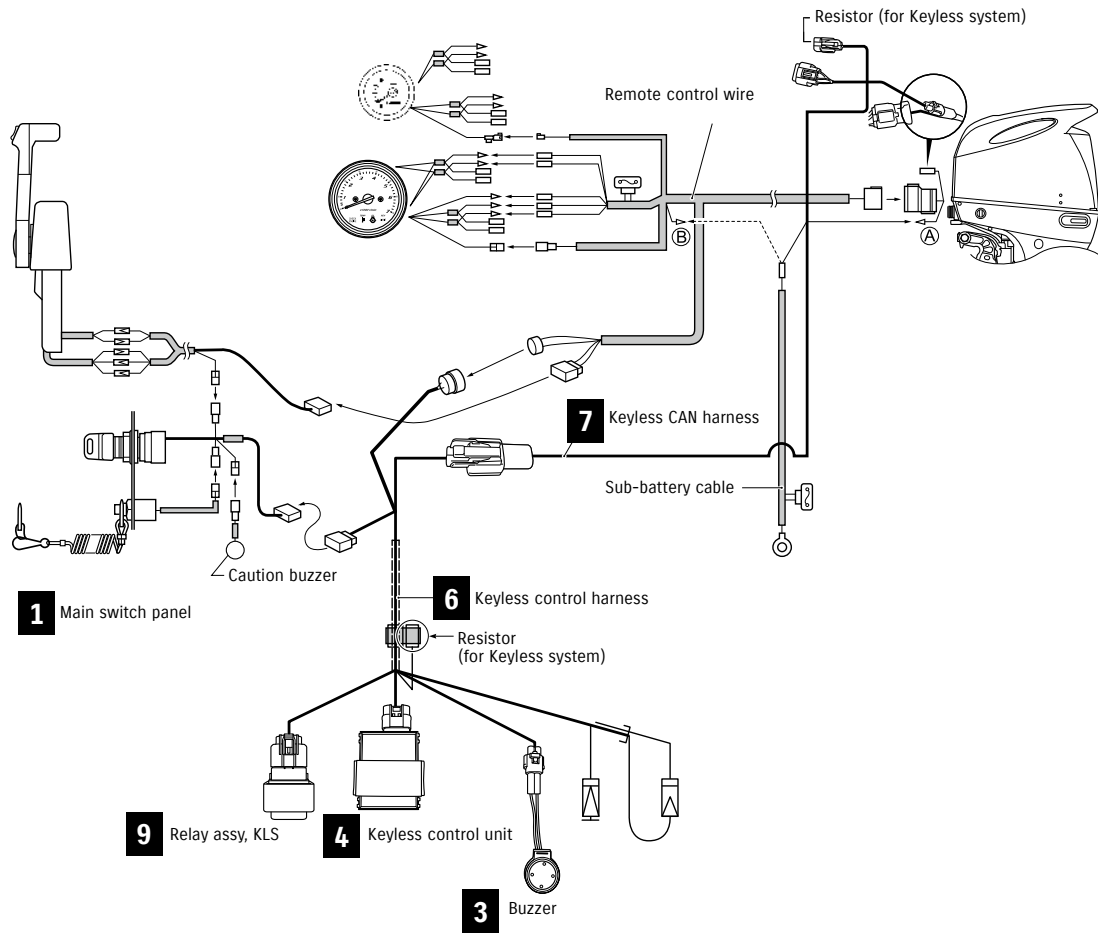

For MECHANICAL REMOTE CONTROL				KIT		Total Required Quantity	
				CONTROLLER SET		HARNES SET	
PART NUMBER	PART NAME	LENGTH	37170-96L07 (433 MHz)	37170-96L16 (315 MHz)	37105-96L13		
1	37100-96L12-000 37100-96L22-000	MAIN SWITCH PANEL	-	-	-	1	-
3	38500-93J90-000	BUZZER	-	-	1	1	1
4	37171-96L03-000 37171-96L12-000	KEYLESS CONTROL UNIT	-	1	-	1	1
5	37172-96L03-000 37172-96L11-000	KEY FOB	-	2	-	2	2
6	36623-96L11-000	KEYLESS CONTROL HARNESS	-	-	1	1	1
7	36662-96L10-000	KEYLESS CAN HARNESS	6.5m	-	1	1	1
8	36664-96L00-000	CAN EXTENSION HARNESS	0.8m	-	-	-	1
9	38860-96L01-000	RELAY ASSY, KLS	-	-	1	1	1
10	37173-96L10-000	HOLDER, KLS PARTS	-	-	1	1	1
13	36621-96L00-000	HARNES ASSY, DUAL KLS ENG	-	-	-	-	1
14	36663-96L10-000	WIRE COMP, KLS CAN EXT	2.0m	-	-	-	1
11	32980-38F00-000	HOLDER	-	-	1	1	1
12	32851-93J00-000	CUSHION	-	-	1	1	1
-	37117-96L00-000	DECAL, KLS	-	2	-	-	-

# COMPONENT PARTS

**1** MAIN SWITCH PANEL



**3** BUZZER



**4** KEYLESS CONTROL UNIT



**5** KEY FOB



**6** KEYLESS CONTROL HARNESS



**7** KEYLESS CAN HARNESS



**8** CAN EXTENSION HARNESS



**9** KEYLESS RELAY ASSY



**10** KEYLESS PARTS HOLDER



**11** HOLDER



**12** CUSHION



	PART NUMBER	PART NAME	LENGTH	NOTE
<b>1</b>	37100-96L12-000	MAIN SWITCH PANEL	-	for SINGLE ENGINE
	37100-96L22-000		-	for DUAL ENGINE
<b>3</b>	38500-93J90-000	BUZZER	-	
<b>4</b>	37171-96L03-000	KEYLESS CONTROL UNIT	-	433MHz
	37171-96L12-000		-	315MHz
<b>5</b>	37172-96L03-000	KEY FOB	-	433MHz
	37172-96L11-000		-	315MHz
<b>6</b>	36623-96L11-000	KEYLESS CONTROL HARNESS	-	
<b>7</b>	36662-96L10-000	KEYLESS CAN HARNESS	6.5m	
<b>8</b>	36664-96L00-000	CAN EXTENSION HARNESS	0.8m	
<b>9</b>	38860-96L01-000	RELAY ASSY, KLS	-	
<b>10</b>	37173-96L10-000	HOLDER, KLS PARTS	-	
<b>11</b>	32980-38F00-000	HOLDER	-	
<b>12</b>	32851-93J00-000	CUSHION	-	

# SUZUKI MULTI-FUNCTION GAUGE

The Suzuki Multi-function Gauge (SMG4) shows the right information, at the right time, all on one user-friendly screen.

Users can view a wide range of important information, including engine rpm, speed and trim angle, engine temp and fuel economy in 13 different measurement units, and total fuel flow for multiple engine installations.

The SMG4 also shows alerts from the engine's sensors and warning systems.

## ANALOGUE TACHO & SPEED MODE

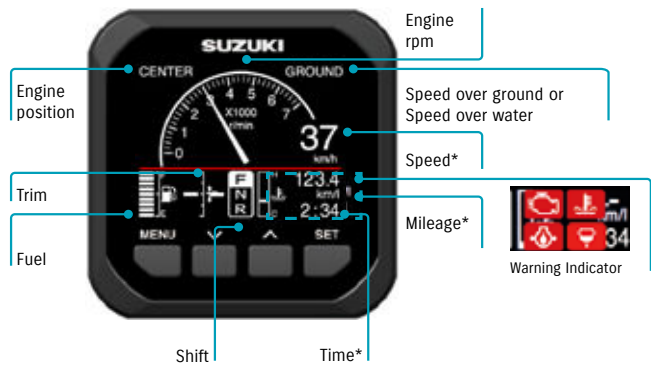

\* Speed sensor or GPS module will be required to display Speed, Mileage, Trip distance, Time information.

## TACHO MODE



- Fuel flow (instantaneous)
- Mileage\* (instantaneous and average)
- Trip time, Trip distance\*
- Engine hour, Voltage, Water temp and more...

	GPS Module	Speed sensor
Speed	<input type="checkbox"/>	<input type="checkbox"/> (SOW)
Mileage	<input type="checkbox"/>	<input type="checkbox"/> (SOW)
Trip distance	<input type="checkbox"/>	<input type="checkbox"/> (SOW)
Time	<input type="checkbox"/>	N/A

(SOW): Speed over water

## TROLL MODE FUNCTION



- Allows you to control your troll mode from the Multi-Function Gauge

This function is available from year 2019 models. Can only be used by models which are adapted to troll mode.

# DISPLAY MODES

**DIGITAL TACHO & SPEED MODE**



**ANALOGUE SPEED MODE**



\*Night mode screen

**FUEL MODE**



# NEW FEATURES

The SMG4 has 3 key new features.

## Multilingual menu

SMG4 is now available in 13 languages: English, French, Italian, German, Spanish, Swedish, Norwegian, Finnish, Dutch, Portuguese, Danish, Russian, Japanese.



## Automatic Trim

Automatically adjusts trim angle with OBM RPM

## Demo mode

Shows preinstalled data to demonstrate function of selected screen. (Ideal for boat shows and exhibitions)



# INSTALLATION DIAGRAM

## S.P.C & SINGLE ENGINE SINGLE STATION

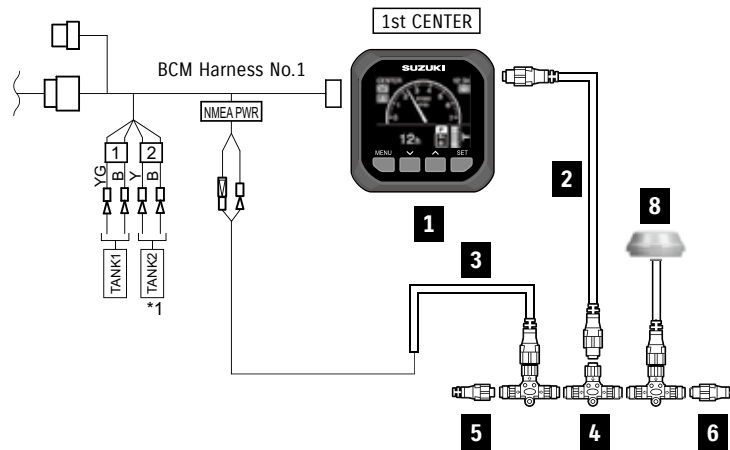

## DUAL STATION

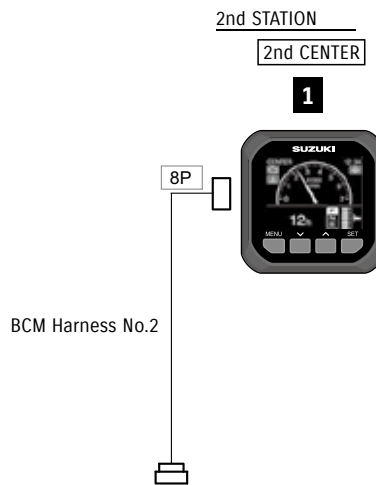

## TOTAL REQUIREMENT LIST

For S.P.C & SINGLE ENGINE				Total Required Quantity					
PART NUMBER	PART NAME	LENGTH	SINGLE STATION	SINGLE STATION (Using Speed over water)	SINGLE STATION (Using Speed over ground)	DUAL STATION	DUAL STATION (Using Speed over water)	DUAL STATION (Using Speed over ground)	
1	34011-96L41-000	GAUGE ASSY, MULTI	1	1	1	2	2	2	
-	36001-88L00-000	CABLE KIT	-	1	1	1	1	1	
8	990C0-88317-000	SENSOR ASSY, PADDLE WHEEL	-	1	-	-	1	-	
	990C0-88122-000	GPS RECEIVER MODULE	-	-	1	-	-	1	

## CABLE KIT COMPONENT

PART NUMBER	PART NAME	LENGTH	Quantity
36001-88L00-000	CABLE KIT	-	-
2	990C0-88104-000	WIRE COMP, EXTENSION	0.6m
3	990C0-88112-000	HARNES ASSY, NETWORK POWER	1
4	990C0-88110-000	CONNECTOR COMP, BRANCH	1
5	990C0-88113-000	UNIT COMP, RESISTOR FEMALE	1
6	990C0-88114-000	UNIT COMP, RESISTOR MALE	1



# S.P.C & DUAL ENGINE

## SINGLE STATION

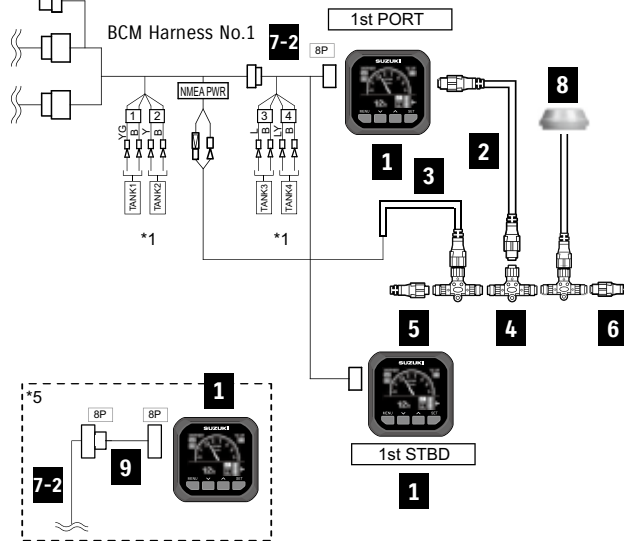

## DUAL STATION

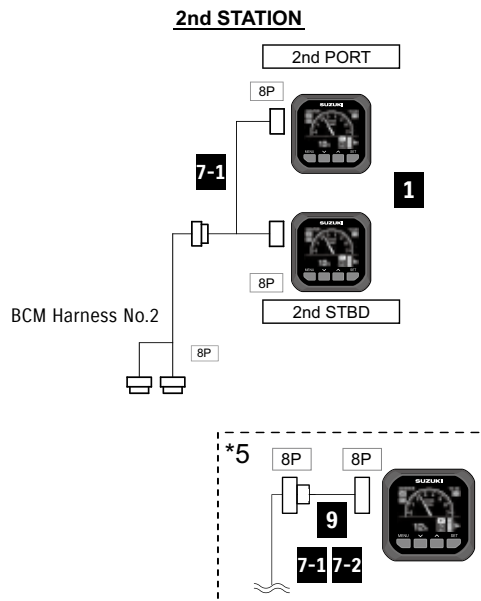

## TOTAL REQUIREMENT LIST

For S.P.C & DUAL ENGINE				Total Required Quantity					
PART NUMBER	PART NAME	LENGTH	Total Required Quantity						
			SINGLE STATION	SINGLE STATION (Using Speed over water)	SINGLE STATION (Using Speed over ground)	DUAL STATION	DUAL STATION (Using Speed over water)	DUAL STATION (Using Speed over ground)	
1	34011-96L41-000	GAUGE ASSY, MULTI	-	2	2	2	4	4	4
-	36001-88L00-000	CABLE KIT	-	-	1	1	1	1	1
7-1	36667-96L40-000	WIRE COMP, GAUGE ADAPTER	-	Choose 1			2*		
7-2	36667-96L50-000	WIRE COMP, GAUGE ADAPTER (FOR TANK3-4)	-	Choose 1			2*		
8	990C0-88317-000	SENSOR ASSY, PADDLE WHEEL	-	-	1	-	-	1	-
8	990C0-88122-000	GPS RECEIVER MODULE	-	-	-	1	-	-	1
9	36667-96L60-000	WIRE COMP, GAUGE EXT	0.6m	-	-	-	Optional		

\* 36667-96L40 x 1 and 36667-96L50 x 1 or 36667-96L40 x 2

# MECHANICAL CONTROL & SINGLE ENGINE

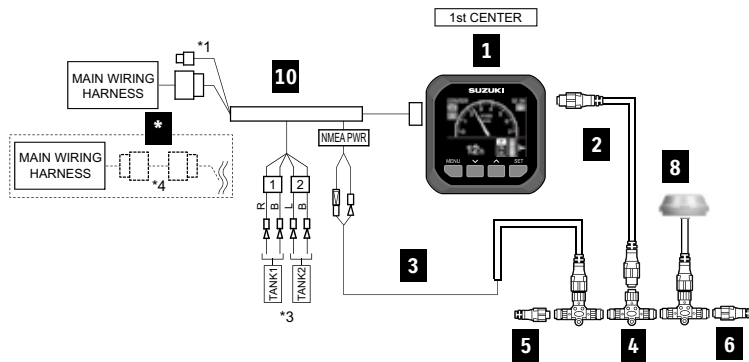

- Basic Kit  
34000-96L48      **A. GAUGE KIT**
- When using GPS module (or Speed over water)  
34000-96L48      **A. GAUGE KIT**  
+36001-88L00      **B. CABLE KIT**
- +39950-88L02      GPS. Receiver Module  
(34190-88L00      When using Speed over water)

+

- When using DF9.9B-DF30A  
**36660-89L02-000**

For MECHANICAL CONTROL & SINGLE ENGINE				KIT		Total Required Quantity A (+ B) <+ * >
				A. GAUGE KIT 34000-96L48-000	B. CABLE KIT 36001-88L00-000	
1	34011-96L41-000	GAUGE ASSY, MULTI	-	1	-	1
2-1	990C0-88104-000	WIRE COMP, EXTENSION	0.6m	-	1	(1)
2-2	990C0-88105-000	WIRE COMP, EXTENSION	1.8m	-	-	(1)
3	990C0-88112-000	HARNESS ASSY, NETWORK POWER	-	-	1	(1)
4	990C0-88110-000	CONNECTOR COMP, BRANCH	-	-	1	(1)
5	990C0-88113-000	UNIT COMP, RESISTOR FEMALE	-	-	1	(1)
6	990C0-88114-000	UNIT COMP, RESISTOR MALE	-	-	1	(1)
8	990C0-88317-000	SENSOR ASSY, PADDLE WHEEL	-	-	-	(1)
	990C0-88122-000	GPS RECEIVER MODULE	-	-	-	(1)
10	36661-96L30-000	ADAPTER COMP, GAUGE	-	1	-	1
*	36660-89L02-000	SET, ENG TO INTERFACE WIRE	-	-	-	<1>

- \*( ) parts are required when using GPS module or Speed sensor.
- \* < > part are required when using with DF9.9B to 30A.



## MECHANICAL CONTROL & DUAL ENGINE

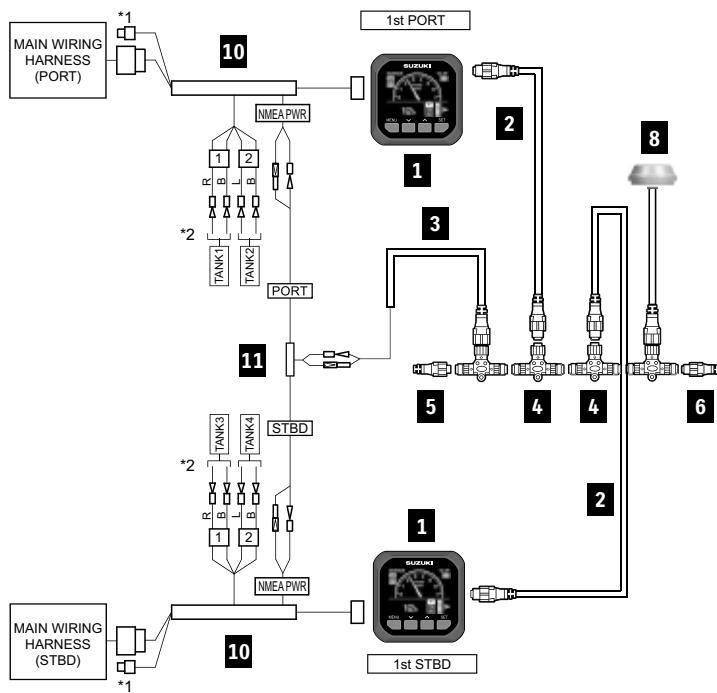

- Basic Kit  
34000-96L58      **A. GAUGE KIT**
- When using GPS module  
34000-96L58      **A. GAUGE KIT**
- +39950-88L02      GPS. Receiver Module  
(34190-88L00)      When using Speed over water

For MECHANICAL CONTROL & DUAL ENGINE				KIT	Total Required Quantity
PART NUMBER	PART NAME	LENGTH	A. GAUGE KIT		
1	34011-96L41-000	GAUGE ASSY, MULTI	2	2	
2-1	990C0-88104-000	WIRE COMP, EXTENSION	2	2	
2-2	990C0-88105-000	WIRE COMP, EXTENSION	-	2	
3	990C0-88112-000	HARNESS ASSY, NETWORK POWER	1	1	
4	990C0-88110-000	CONNECTOR COMP, BRANCH	2	2	
5	990C0-88113-000	UNIT COMP, RESISTOR FEMALE	1	1	
6	990C0-88114-000	UNIT COMP, RESISTOR MALE	1	1	
8	990C0-88317-000	SENSOR ASSY, PADDLE WHEEL	-	(1)	
	990C0-88122-000	GPS RECEIVER MODULE	-	(1)	
10	36661-96L30-000	ADAPTER COMP, GAUGE	2	2	
11	36665-87L10-000	ADAPTER, GAUGE FOR MULTI	1	1	

■ \*( )parts are required when using GPS module or Speed sensor.

## ADDITIONAL GAUGE COMPONENTS (MECHANICAL)

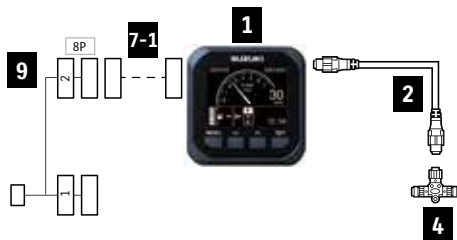

ADDITIONAL GAUGE COMPONENTS (MECHANICAL)				Total Required Quantity
PART NUMBER	PART NAME	LENGTH		
1	34011-96L41-000	GAUGE ASSY, MULTI	-	1
2-1	990C0-88104-000	WIRE COMP, EXTENSION	0.6m	1
2-2	990C0-88105-000	WIRE COMP, EXTENSION	1.8m	1
4	990C0-88110-000	CONNECTOR COMP, BRANCH	-	1
7-1	36667-96L40-000	WIRE COMP, DUAL GAUGE ADAPTER	-	1
9	36667-96L60-000	WIRE, GAUGE EXT	0.6m	(1)

Please use "36667-96L60-000 WIRE, GAUGE EXT" as an extension between "34011-96L41" and "36667-96L40"

# COMPONENT PARTS

**1** GAUGE ASSY,  
MULTI



34011-96L41-000

**2** WIRE COMP,  
EXTENSION



**2-1** 990C0-88104-000  
0.6 meters

**2-2** 990C0-88105-000  
1.8 meters

**3** HARNESS ASSY,  
NETWORK POWER



990C0-88112-000

**4** CONNECTOR COMP,  
BRANCH



990C0-88110-000

**5** UNIT COMP,  
RESISTOR FEMALE



990C0-88113-000

**6** UNIT COMP,  
RESISTOR MALE



990C0-88114-000

**7** WIRE COMP,  
GAUGE ADAPTER



**7-1** 36667-96L40-000

**7-2** 36667-96L50-000  
for Tank 3-4

**8** SENSOR ASSY,  
PADDLE WHEEL



990C0-88317-000

GPS RECEIVER  
MODULE



990C0-88122-000

**9** WIRE COMP, GAUGE EXT (0.6m)

**36667-96L60-000**  
0.6 meters

**10** ADAPTER COMP, GAUGE

**36661-96L30-000**  
for Dual Engine

**11** ADAPTER,  
GAUGE FOR MULTI



**36665-87L10-000**  
In addition to component of  
[MECHANICAL SINGLE]





# SUZUKI DIAGNOSTIC SYSTEM MOBILE

SDS Mobile works in tandem with our Multi-Function Gauge and Multi-Function Display. Simply download the App, available on iOS and Android, to your smartphone: you don't need a separate device. When you email your data scanned from QR code to the Dealer, they will be supplied of information including engine number, number of hours since the last oil change, total hours of operation at different rpm, and other technical information.

\*DENSO WEB owns the right of name and logo of QR code.



## HOW IT WORKS

1. The Outboard converts engine data into a QR code displayed on the Multi-Function Gauge or Multi-Function Display.
2. Customer can use their smart phone to scan the QR code with the SDS Mobile App. The engine data will be stored on their smart phone.
3. Customer can then send the engine data via email to your Suzuki Dealer.

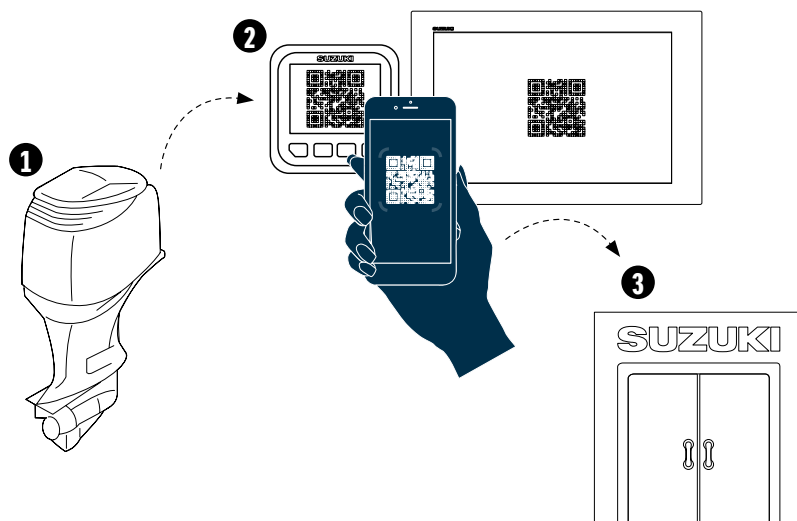

DOWNLOAD THE APP FROM:



Apple and the Apple logo are trademarks of Apple Inc., registered in the U.S. and other countries. App Store is a service mark of Apple Inc., registered in the U.S. and other countries.



Google Play and the Google Play logo are trademarks of Google LLC.



Find out more at our Global Homepage

SDS Mobile App and email service are entirely free of charge.



OPERATION SYSTEMS

DIAGNOSTIC MOBILE APP



# ANALOGUE INSTRUMENT

## TACHOMETER



White



Black



White



Black



White



Black

**34200-93J14-000** (White)

**34200-93J02-000** (Black)

Gauge Size 4" (101.6mm)

Applicable Model DF25A-250

Caution system alert with a monitor lamp lighting on when an abnormal engine condition occurs. Refer to SERVICE MANUAL for the detail.

**34200-93J53-000** (White)

**34200-93J42-000** (Black)

Gauge Size 4" (101.6mm)

Applicable Model DF40A-200A

Exclusive for SUZUKI TROLL Mode System. Automatically switches to low RPM scale when the SUZUKI Troll Mode System is activated.

**34200-93J34-000** (White)

**34200-93J22-000** (Black)

Gauge Size 4" (101.6mm)

Applicable Model DF8A-30A

Full-scale 7000-RPM TACHOMETER can be used on electric-start models by using 4, 6 or 12 pole switch on rear of meter.

## TRIM GAUGE



White



Black

**34800-93J13-000** (White)

**34800-93J02-000** (Black)

Gauge Size 2" (50.8mm)

Applicable Model DF25A-250

Magnetic-type gauge shows trim angle for optimum performance and efficiency.

## FUEL GAUGE



White



Black

**34300-93J13-000** (White)

**34300-93J02-000** (Black)

Gauge Size 2" (50.8mm)

FUEL GAUGE alone works with the US Standard 250Q sending unit.

## HOUR METER



White



Black

**34500-93J13-000** (White)

**34500-93J02-000** (Black)

Gauge Size 2" (50.8mm)

Applicable Model DF9.9B-250

12-Volt-electric-motor driven meter indicates hours that your SUZUKI OUTBOARD MOTOR has been operated in order for you to know when each periodic service is required.



**SPEEDOMETER**



White

(White)

**34100-93J13-000**

Gauge Size 4" (101.6mm)

Maximum Speed 130km/h, 80mph

Bourdon-tube type speedometer with readings in km/h and mph. Includes vinyl tube, hardware and installation manual.



Black

(Black)

**34100-93J02-000**



White

(White)

**34100-93J33-000**

Gauge Size 4" (101.6mm)

Maximum Speed 80km/h, 50mph

Bourdon-tube type speedometer with readings in km/h and mph. Includes vinyl tube, hardware and installation manual.



Black

(Black)

**34100-93J22-000**



White

(White)

**34100-93J53-000**

Gauge Size 4" (101.6mm)

Maximum Speed 80km/h, 45knots

Bourdon-tube type speedometer with readings in km/h and knots. Includes vinyl tube, hardware and installation manual.



Black

(Black)

**34100-93J42-000**



**34100-93J62-000**

Gauge Size 4" (101.6mm)

Background White

Maximum Speed 120km/h, 65knots

Bourdon-tube type speedometer with readings in km/h and knots. Includes vinyl tube, hardware and installation manual.

**SPEEDOMETER SENDER ASSY**



**34190-95500-000**



**34190-87D00-000**

**VOLTMETER**



White

Black

**34600-93J13-000** (White)

**34600-93J02-000** (Black)

Gauge Size 2" (50.8mm)

Applicable Model DF9.9B-250

To help your SUZUKI OUTBOARD MOTOR run at its best, monitor the charging system functioning with a VOLTMETER.

**WATER-PRESSURE GAUGE**



White

Black

**34650-93J33-000** (White)

**34650-93J22-000** (Black)

Gauge Size 2" (50.8mm)

Applicable Model DF40A-250

Bourdon-tube type gauge measures cooling-water pressure. Select an appropriate INSTALLATION KIT for each model.

**INSTALLATION KIT for WATER-PRESSURE GAUGE**



**34660-90J04-000**

Applicable Model DF40A-140A

**34660-96J01-000**

Applicable Model DF150-175/200A

**34660-93J02-000**

Applicable Model DF200-250

KIT includes fittings and hoses needed for motor to gauge connection.



# STEERING

## TILLER HANDLE KIT



### 63002-88L29-YAY

Applicable Model  
DF40A/50A

### 63002-88L17-YAY

Applicable Model  
DF60A/50AV/60AV

### 63002-87L17-YAY

Applicable Model  
DF70A-90A/100B

### 63002-90J38-YAY

Applicable Model  
DF100A/115BT

## Main features



**Tachometer with warning indicators**

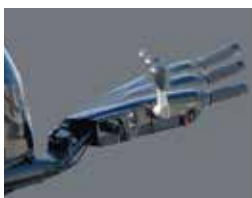

**Three-position angle adjustable bracket**



**Troll mode switch**

- Activates SUZUKI Troll Mode System and controls RPM from idling engine speed up to 1200rpm at every 50rpm.



**Power trim & tilt switch and throttle grip friction adjuster**



## DUAL-ENGINE TIE-BAR



### 67600-99L00-000

Stainless steel

Applicable Model DF100A-140A

### 67600-90L00-000

Stainless steel

Applicable Model DF115BG/140BG

### 67600-93J00-000

Stainless steel

Applicable Model DF150A-200A/200-250  
DF150AP-200AP

## STEERING EXTENSION KIT



### 67630-93J00-000

for installation of DUAL-ENGINE TIE-BAR  
(67600-93J00-000)

Applicable Model DF150A-200A/200-250

## DRAG-LINK KIT \*67700- includes Steering Cable Seal



### 67700-87L10-000

Applicable Model DF70A-90A/100B  
22MY and later

### 67700-93J00-000

Applicable Model DF40A-60A/200-250

### 67700-96J00-000

Applicable Model DF150A-200A/  
150AP-200AP

### 67701-87J11-000

Applicable Model DF40A-60A/200-250

### 67701-87L10-000

Applicable Model DF70A-90A/100B  
22MY and later

### 67701-90J01-000

Applicable Model DF100A-140A

### 67701-96J00-000

Applicable Model DF150A-200A/  
150AP-200AP

### 67701-94L00-000

Applicable Model DF25A/30A

### 67701-99J02-000

Applicable Model DF8A-DF20A

## STEERING-BRACKET ATTACHMENT



### 43755-87L00-000

Applicable Model DF70A-90A/100B

### 43755-88L00-000

Applicable Model DF40A-60A

### 43755-94L00-000

Applicable Model DF25A-30A

### 43755-99J00-000

Applicable Model DF8A-20A

## STEERING CABLE SEAL



### 41161-94400-000

Applicable Model DF8A-250

# ELECTRICAL PARTS

## BATTERY CHARGING KIT

- Optional equipment for charging Battery
- Applicable models : DF4A/5A/6A, DF8A/9.9A, DF9.9B/15A/20A, DF25A/30A.

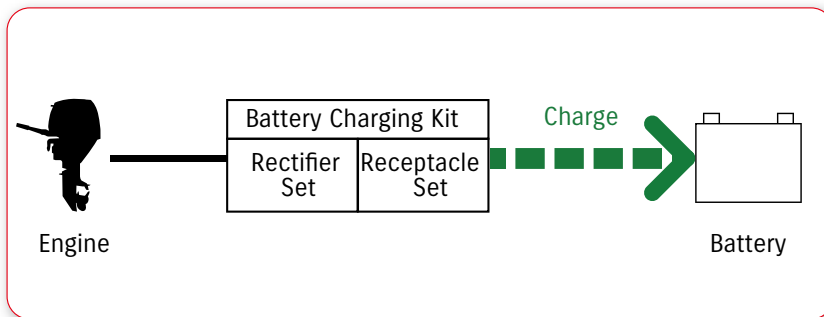

APPLICABLE MODEL	BATTERY CHARGING KIT ├ RECTIFIER and REGULATOR SET └ RECEPTACLE KIT
DF4A/5A/6A	32000-97L03-000 ├ 32801-97L01-000 └ 39600-97L02-000
DF8A/9.9A	32000-99J03-000 ├ 32801-95J03-000 └ 39600-94J03-000
DF9.9B/15A/20A	32000-89L03-000 ├ 32801-89L01-000 └ 39600-89L02-000
DF25A/30A	32000-94L02-000 ├ 32800-88L01-000 ├ 39600-94L00-000 ├ 32815-94L00-000 (BRACKET) └ 01550-06207-000 (BOLT)

## ELECTRIC STARTER KIT

- Optional materials for Converting Manual Starter model into Electric Starter model.
- \* Electric Starter Kit functions as Battery charging Kit as well.

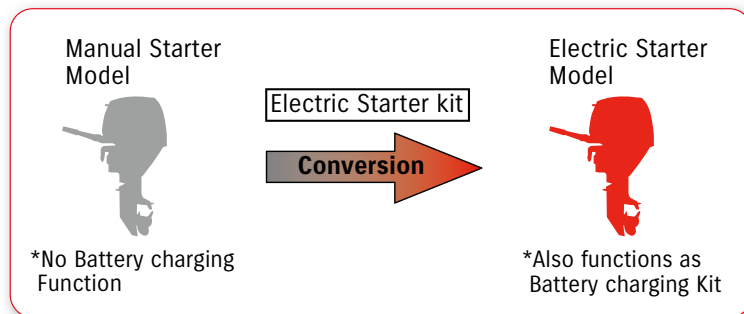

\*No Battery charging Function

\*Also functions as Battery charging Kit

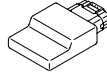
APPLICABLE MODEL	ELECTRIC STARTER KIT
DF4A/5A/6A	—
DF8A/9.9A	31000-99J11-000
DF25A/30A	31000-94L09-000
DF9.9B/15A/20A	31000-89L09-000 (For ~17MY) 31000-89L21-000 (For 18MY-)
	DF9.9B: 33930-89L40-000 DF15A: 33930-89L00-000 DF20A: 33930-89L20-000 DF20A(P40): 33930-89L60-000



## BATTERY ISOLATOR LEAD SET

Optional equipment for charging additional battery.

### 33830-98J11-000

Applicable Model DF150A-200A/  
150AP-300AP/  
325A/350A



# FUEL SYSTEM

## FUEL TANK

NOTE : These tanks do not meet US-EPA requirements.



### 65000-99100-000

12-liter plastic tank without fuel-level gauge

Applicable Model DF4A/5A/6A

### 65000-94L10-000

25-liter plastic tank with a fuel-level gauge

Applicable Model DF8A-140A

### 65000-89L10-000

12-liter plastic tank

Applicable Model DF4A-20A

## REPLACEMENT FUEL CAP

NOTE : Not US-EPA compatible.

### 65520-99100-000

Applicable Model DF5A-20A/R

## FUEL-HOSE SOCKET



### 65750-98506-000

Metal, Inner diameter: 11.2 mm

Applicable Model DF4A-20A/R



### 65750-87J11-000

Plastic, Inner diameter: 6.6 mm

Applicable Model DF4A/8A-30A



### 65750-95501-000

Metal, Inner diameter: 13.0 mm

Applicable Model DF8A/R-140A

## FUEL CONNECTOR



### 65720-986B0-000

Engine side, Plastic

Applicable Model DF4A



### 65740-95D01-000

Tank side, Outer diameter: 13 mm, 1/4"NPT

Applicable Model DF8A/R-140A

## SQUEEZE PUMP



### 65770-90J13-000

Large-in & Large-out

Applicable Model DF8A-20A/40A-140A

### 65770-93J13-000

Large-in & Large-out

Applicable Model DF150-350A

## FUEL-HOSE

### 09352-73124-00D

I/D 7.3 , O/D 12.5

LENGTH 4,000mm

Not US-EPA compatible

## FUEL-HOSE COMPONENT



### 65700-87J19-000

for 25-liter plastic tank to engine

Applicable Model DF8A-20A

### 65700-90J18-000

for 25-liter plastic tank to engine

Applicable Model DF40A-60A

### 65700-90J24-000

for 25-liter plastic tank to engine

Applicable Model DF70A-140A

### 65700-93J14-000

for fuel tank to engine

Applicable Model DF150-350A

## FUEL-HOSE COMPONENT

(US-EPA compatible.)

### 65700-87J28-000

Applicable Model DF5A-30A

### 65700-88L06-000

Applicable Model DF40A-60A

## SQUEEZE PUMP

(US-EPA compatible.)

### 65770-90J04-000

Large-in & Large-out

Applicable Model DF8A-140A

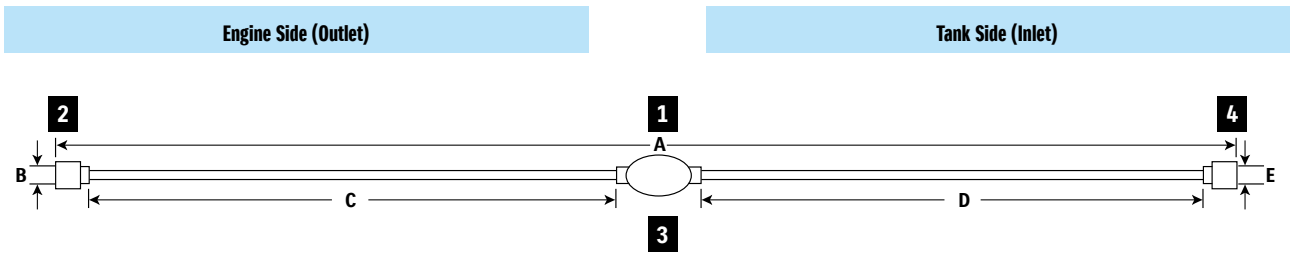

## FUEL-HOSE COMPONENT Chart



1		2		-				3		-				4	
FUEL HOSE COMPONENT		SOCKET		HOSE				SQUEEZE PUMP		HOSE				SOCKET	
Part Number	A Length (mm)	Material	B I/D (mm)	Part Number	C Length (mm)	I/D (mm)	O/D (mm)	SQUEEZE PUMP	D Length (mm)	I/D (mm)	O/D (mm)	Material	E I/D (mm)	Part Number	
65700-87J19-000	1970	Plastic	6.6	65750-87J11-000	700	7.3	12.5	65770-90J13-000	1100	7.3	12.5	Metal	13.0	65750-95501-000	
65700-90J18-000	1250	(no socket)	-	-	(no hose)	-	-	65770-90J13-000	1100	7.3	12.5	Metal	13.0	65750-95501-000	
65700-90J24-000	1250	(no socket)	-	-	(no hose)	-	-	65770-90J13-000	1100	7.3	12.5	Metal	13.0	65750-95501-000	
65700-93J14-000	2370	(no socket)	-	-	(no hose)	-	-	65770-93J13-000	2250	Large	9.0	14.0	(no socket)	-	
65700-87J28-000	2000	Plastic	6.6	65750-87J11-000	700	7.3	12.5	65770-90J03-000	1100	7.3	12.5	Metal	13.0	65750-95501-000	
65700-88L06-000	1280	(no socket)	-	-	(no hose)	-	-	65770-90J03-000	1100	7.3	12.5	Metal	13.0	65750-95501-000	

## WATER SEPARATOR / FUEL FILTER



### 65900-98J11-000

Applicable Model DF5A-DF140A

### 65900-98J21-000

Applicable Model DF150A-DF350A

## WATER SEPARATOR/FUEL FILTER ELEMENT SET



### 65910-98J01-000

Applicable Model DF5A-DF350A



# SUZUKI PROPELLERS

## WATERGRIP

\*This picture was taken remotely

### WATERGRIP



The WATERGRIP series will be the new standard for Suzuki propellers. The interchangeable square-shaped bush system is designed for quick and easy replacement when required, and also accurately and efficiently converts power from the engine to thrust through the propeller.



### WATERGRIP DUAL



Our flagship models, the DF350A, DF325A and DF300B, introduced the Suzuki Dual Prop System, an industry-leading technology, which delivers outstanding and exciting performance. The two contra-rotating propellers, operating simultaneously, enables greater conversion efficiency as well as better stability, grip, and manoeuvrability.



### WATERGRIP SPORT



The WATERGRIP SPORT propellers feature a high rake blade design for excellent acceleration and exceptional top speed. These propellers are ideal for lightweight sports boats as they give remarkably stable thrust when turning for superior manoeuvrability.





Model	Type	Material	Blade	Diameter		Pitch		Rotation*	Part number
				in	(mm)	in	(mm)		
DF150	Watergrip	Stainless	3	16	(406.4)	15	(381)	RR	58700-93L80-000
DF150AP	Watergrip	Stainless	3	16	(406.4)	17	(431.8)	RR	58700-93L00-000
DF175	Watergrip	Stainless	3	16	(406.4)	18 1/2	(469.9)	RR	58700-93L10-000
DF175AP	Watergrip	Stainless	3	16	(406.4)	20	(508)	RR	58700-93L20-000
DF200	Watergrip	Stainless	3	16	(406.4)	21 1/2	(546.1)	RR	58700-93L30-000
DF200A	Watergrip	Stainless	3	16	(406.4)	23	(584.2)	RR	58700-93L40-000
DF200AP	Watergrip	Stainless	3	16	(406.4)	24 1/2	(622.3)	RR	58700-93L50-000
DF225	Watergrip	Stainless	3	16	(406.4)	26	(660.4)	RR	58700-93L60-000
DF250	Watergrip	Stainless	3	16	(406.4)	27 1/2	(698.5)	RR	58700-93L70-000
DF250AP	Watergrip	Stainless	3	16	(406.4)	17	(431.8)	CR	58800-93L00-000
DF300AP	Watergrip	Stainless	3	16	(406.4)	18 1/2	(469.9)	CR	58800-93L10-000
	Watergrip	Stainless	3	16	(406.4)	20	(508)	CR	58800-93L20-000
	Watergrip	Stainless	3	16	(406.4)	21 1/2	(546.1)	CR	58800-93L30-000
	Watergrip	Stainless	3	16	(406.4)	23	(584.2)	CR	58800-93L40-000
	Watergrip	Stainless	3	16	(406.4)	24 1/2	(622.3)	CR	58800-93L50-000
	Watergrip	Stainless	3	16	(406.4)	26	(660.4)	CR	58800-93L60-000
	Watergrip	Stainless	3	15 1/2	(393.7)	17	(431.8)	RR	58700-96J00-000
	Watergrip	Stainless	3	15 1/4	(387.4)	19	(482.6)	RR	58700-96J10-000
	Watergrip	Stainless	3	15	(381)	21	(533.4)	RR	58700-96J20-000
	Watergrip	Stainless	3	14 3/4	(374.7)	23	(584.2)	RR	58700-96J30-000
	Watergrip	Stainless	3	14 1/2	(368.3)	25	(635)	RR	58700-96J40-000
	Watergrip	Stainless	3	14 1/2	(368.3)	27	(685.8)	RR	58700-96J50-000
	Watergrip	Stainless	3	15 1/2	(393.7)	17	(431.8)	CR	58800-96J00-000
	Watergrip	Stainless	3	15 1/4	(387.4)	19	(482.6)	CR	58800-96J10-000
	Watergrip	Stainless	3	15	(381)	21	(533.4)	CR	58800-96J20-000
	Watergrip	Stainless	3	14 3/4	(374.7)	23	(584.2)	CR	58800-96J30-000
	Watergrip	Stainless	3	14 1/2	(368.3)	25	(635)	CR	58800-96J40-000
	Watergrip	Stainless	3	14 1/2	(368.3)	27	(685.8)	CR	58800-96J50-000
	Watergrip	Stainless	4	15 1/4	(387.4)	18	(457.2)	RR	58700-93J00-000
	Watergrip	Stainless	4	15 1/4	(387.4)	20	(508)	RR	58700-93J10-000
	Watergrip	Stainless	4	15 1/4	(387.4)	22	(558.8)	RR	58700-93J20-000
	Watergrip	Stainless	4	15 1/4	(387.4)	24	(609.6)	RR	58700-93J30-000
	Watergrip	Stainless	4	15 1/4	(387.4)	26	(660.4)	RR	58700-93J40-000
	Watergrip	Stainless	4	15 1/4	(387.4)	20	(508)	CR	58800-93J10-000
	Watergrip	Stainless	4	15 1/4	(387.4)	22	(558.8)	CR	58800-93J20-000
	Watergrip	Stainless	4	15 1/4	(387.4)	24	(609.6)	CR	58800-93J30-000
	Watergrip	Stainless	4	15 1/4	(387.4)	26	(660.4)	CR	58800-93J40-000
	Watergrip Sport	Stainless	3	15	(381)	19	(482.6)	RR	58700-96L00-000
	Watergrip Sport	Stainless	3	14 7/8	(377.8)	21	(533.4)	RR	58700-96L10-000
	Watergrip Sport	Stainless	3	14 1/2	(368.3)	23	(584.2)	RR	58700-96L20-000
	Watergrip Sport	Stainless	3	14 1/4	(362)	25	(635)	RR	58700-96L30-000
	Watergrip Sport	Stainless	3	14	(355.6)	27	(685.8)	RR	58700-96L40-000

\* Be sure to install both front and rear propellers in the same pitch.

Model	Type	Material	Blade	Diameter		Pitch		Part number
				in	(mm)	in	(mm)	
DF300B	Watergrip Dual	Stainless	3	15 1/2	(393.7)	12	(304.8)	58500-98LA0-000 (Front)
DF325A								58600-98LA1-000 (Rear)
DF350A	Watergrip Dual	Stainless	3	15 1/2	(393.7)	15	(381)	58500-98LB0-000 (Front)
								58600-98LB1-000 (Rear)
	Watergrip Dual	Stainless	3	15 1/2	(393.7)	16 1/2	(419.1)	58500-98LC0-000 (Front)
								58600-98LC1-000 (Rear)
	Watergrip Dual	Stainless	3	15 1/2	(393.7)	18	(457.2)	58500-98L90-000 (Front)
								58600-98L91-000 (Rear)
	Watergrip Dual	Stainless	3	15 1/2	(393.7)	19 1/2	(495.3)	58500-98L60-000 (Front)
								58600-98L61-000 (Rear)
	Watergrip Dual	Stainless	3	15 1/2	(393.7)	21	(533.4)	58500-98L00-000 (Front)
								58600-98L01-000 (Rear)
	Watergrip Dual	Stainless	3	15 1/2	(393.7)	22 1/2	(571.5)	58500-98L10-000 (Front)
								58600-98L11-000 (Rear)
	Watergrip Dual	Stainless	3	15 1/2	(393.7)	24	(609.6)	58500-98L20-000 (Front)
								58600-98L21-000 (Rear)
	Watergrip Dual	Stainless	3	15 1/2	(393.7)	25 1/2	(647.7)	58500-98L30-000 (Front)
								58600-98L31-000 (Rear)
	Watergrip Dual	Stainless	3	15 1/2	(393.7)	27	(685.8)	58500-98L40-000 (Front)
								58600-98L41-000 (Rear)
	Watergrip Dual	Stainless	3	15 1/2	(393.7)	28 1/2	(723.9)	58500-98L50-000 (Front)
								58600-98L51-000 (Rear)
	Watergrip Dual	Stainless	3	15 1/2	(393.7)	30	(762)	58500-98L70-000 (Front)
								58600-98L71-000 (Rear)
	Watergrip Dual	Stainless	3	15 1/2	(393.7)	31 1/2	(800.1)	58500-98L80-000 (Front)
								58600-98L81-000 (Rear)

## THE NEW WATERGRIP RANGE

WATERGRIP is a stainless-steel propeller series offering accurate response to User operation. Converting engine power into propulsion with high efficiency, this propeller series meets our customer's demand for bigger, faster, more powerful outboards.

The WATERGRIP propeller series employs a new interchangeable and square shaped propeller bush that minimises power loss in delivery.

### PROPELLER BUSH ADVANTAGES

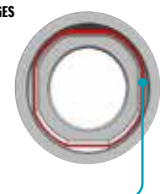

Better resistance over

propeller slip

Interchangeable bush

# PROPELLER LINE-UP

Model	Type	Material	Blade	Diameter		Pitch		Rotation*	Description	Part number
				in	(mm)	in	(mm)			
<b>DF2.5</b>	A520	Aluminum	3	7 3/8	(187.3)	5 3/8	(136.5)	RR		58110-97JA0-019
<b>DF4A</b>	C601	Aluminum	3	7 1/2	(190.5)	6	(152.4)	RR		58110-91JL0-019
<b>DF5A</b>	C611	Aluminum	3	7 1/2	(190.5)	6 1/2	(165.1)	RR		58110-91JM0-019
<b>DF6A</b>	C701	Aluminum	3	7 1/2	(190.5)	7	(177.8)	RR		58110-91JN0-019
<b>DF8A</b>	M701	Aluminum	3	9 1/4	(235)	7	(177.8)	RR		58100-89L00-019
<b>DF9.9A</b>	M821	Aluminum	3	9 1/4	(235)	8	(203.2)	RR	THICK	58100-90L41-019
	M901	Aluminum	3	9 1/4	(235)	9	(228.6)	RR		58100-89L20-019
	M911	Aluminum	3	9 1/4	(235)	9	(228.6)	RR	THICK	58100-90L50-019
	M1001	Aluminum	3	9 1/4	(235)	10	(254)	RR		58100-89L60-019
	M1011	Aluminum	3	9 1/4	(235)	10	(254)	RR	THICK	58100-90L21-019
	M1101	Aluminum	3	9 1/4	(235)	11	(279.4)	RR		58100-89L70-019
<b>DF9.9B</b>		Aluminum	4	10	(254)	5	(127)	RR	High thrust	58100-94JA2-019
<b>DF15A</b>		Aluminum	4	10	(254)	7	(177.8)	RR	High thrust	58100-94JB1-019
<b>DF20A</b>		Aluminum	3	9 1/4	(235)	7	(177.8)	RR		58100-89L00-019
		Aluminum	3	9 1/4	(235)	8	(203.2)	RR	THICK	58100-90L41-019
		Aluminum	3	9 1/4	(235)	9	(228.6)	RR		58100-89L20-019
		Aluminum	3	9 1/4	(235)	9	(228.6)	RR	THICK	58100-90L50-019
		Aluminum	3	9 1/4	(235)	10	(254)	RR		58100-89L60-019
		Aluminum	3	9 1/4	(235)	10	(254)	RR	THICK	58100-90L60-019
		Aluminum	3	9 1/4	(235)	11	(279.4)	RR		58100-89L70-019
		Aluminum	3	9 1/4	(235)	12	(304.8)	RR		58100-89L50-019
<b>DF25A</b>	P911	Aluminum	3	10 1/4	(260.3)	9	(228.6)	RR	THICK	58100-96372-019
<b>DF30A</b>	P1001	Aluminum	3	10 1/4	(260.3)	10	(254)	RR		58100-91L40-019
	P1011	Aluminum	3	10 1/4	(260.3)	10	(254)	RR	THICK	58100-96472-019
	P1101	Aluminum	3	10 1/4	(260.3)	11	(279.4)	RR		58100-91L50-019
	P1201	Aluminum	3	10 1/4	(260.3)	12	(304.8)	RR		58100-91L20-019
	P1211	Aluminum	3	10 1/4	(260.3)	12	(304.8)	RR	THICK	58100-96482-019
	P1301	Aluminum	3	10 1/4	(260.3)	13	(330.2)	RR		58100-91L30-019
	P1311	Aluminum	3	10 1/4	(260.3)	13	(330.2)	RR	THICK	58100-96492-019
	P1401	Aluminum	3	10 1/4	(260.3)	14	(355.6)	RR		58100-95D01-019
	P1501	Aluminum	3	10 1/4	(260.3)	15	(381)	RR		58100-96462-019
<b>DF40A</b>	S900	Aluminum	3	11 1/2	(292.1)	9	(228.6)	RR		58100-88LC0-019
<b>DF50A</b>	S1000	Aluminum	3	11 1/2	(292.1)	10	(254)	RR		58100-88LD0-019
<b>DF60A</b>	S1100	Aluminum	3	11 1/2	(292.1)	11	(279.4)	RR		58100-88LE0-019
	S1200	Aluminum	3	11 5/8	(295.3)	12	(304.8)	RR		58100-88LA0-019
	S1301	Aluminum	3	11 1/2	(292.1)	13	(330.2)	RR		58100-88LB0-019
	S1400	Aluminum	3	11 3/8	(288.9)	14	(355.6)	RR		58100-88L52-019
	S1500	Aluminum	3	11 1/4	(285.8)	15	(381)	RR		58100-88L62-019
	S1600	Aluminum	3	11 1/8	(282.6)	16	(406.4)	RR		58100-88L72-019
	S1700	Aluminum	3	11	(279.4)	17	(431.8)	RR		58100-88LF0-019
	SS1600	Stainless	3	11 1/8	(282.6)	16	(406.4)	RR		58200-88L30-000
<b>DF50AV</b>		Aluminum	3	14	(355.6)	9	(228.6)	RR		58100-87LG1-019
<b>DF60AV</b>		Aluminum	3	14	(355.6)	11	(279.4)	RR		58100-87LH0-019
		Aluminum	3	13 3/4	(349.3)	12	(304.8)	RR		58100-87LJ0-019
		Aluminum	3	14	(355.6)	13	(330.2)	RR		58100-87LA0-019
		Aluminum	3	13 7/8	(352.4)	15	(381)	RR		58100-87LB0-019
		Aluminum	3	13 3/4	(349.3)	17	(431.8)	RR		58100-87LC0-019
<b>DF70A</b>		Aluminum	3	14	(355.6)	13	(330.2)	RR		58100-87LA0-019
<b>DF80A</b>		Aluminum	3	13 7/8	(352.4)	15	(381)	RR		58100-87LB0-019
<b>DF90A</b>		Aluminum	3	13 3/4	(349.3)	17	(431.8)	RR		58100-87LC0-019
<b>DF100B</b>		Aluminum	3	13 3/4	(349.3)	19	(482.6)	RR		58100-87LD0-019
		Aluminum	3	13 3/4	(349.3)	21	(533.4)	RR		58100-87LE0-019
		Aluminum	3	13 3/4	(349.3)	23	(584.2)	RR		58100-87LF0-019
		Aluminum	3	13 1/2	(342.9)	15	(381)	RR		58100-90JE0-019
		Aluminum	3	14	(355.6)	17	(431.8)	RR		58100-90JA0-019
		Aluminum	3	14	(355.6)	19	(482.6)	RR		58100-90JB0-019
		Aluminum	3	14	(355.6)	21	(533.4)	RR		58100-90JC0-019
		Aluminum	3	14	(355.6)	23	(584.2)	RR		58100-90JD0-019
		Stainless	3	13 7/8	(352.4)	15	(381)	RR		58200-92J40-000
		Stainless	3	13 7/8	(352.4)	17	(431.8)	RR		58200-92J50-000
		Stainless	3	13 7/8	(352.4)	19	(482.6)	RR		58200-92J60-000
		Stainless	3	13 7/8	(352.4)	21	(533.4)	RR		58200-92J70-000
		Stainless	3	13 7/8	(352.4)	23	(584.2)	RR		58200-92J80-000
		Stainless	3	13 7/8	(352.4)	25	(635)	RR		58200-92J90-000

\*RR:Regular-Rotation model, CR:Counter-Rotation model

Model	Type	Material	Blade	Diameter		Pitch		Rotation*	Description	Part number
				in	(mm)	in	(mm)			
DF100A		Aluminum	3	13 1/2	(342.9)	15	(381)	RR		58100-90JE0-019
DF115A		Aluminum	3	14	(355.6)	17	(431.8)	RR		58100-90JA0-019
DF115BG		Aluminum	3	14	(355.6)	19	(482.6)	RR		58100-90JB0-019
DF140A		Aluminum	3	14	(355.6)	21	(533.4)	RR		58100-90JC0-019
DF140BG		Aluminum	3	14	(355.6)	23	(584.2)	RR		58100-90JD0-019
		Stainless	3	13 7/8	(352.4)	15	(381)	RR		58200-92J40-000
		Stainless	3	13 7/8	(352.4)	17	(431.8)	RR		58200-92J50-000
		Stainless	3	13 7/8	(352.4)	19	(482.6)	RR		58200-92J60-000
		Stainless	3	13 7/8	(352.4)	21	(533.4)	RR		58200-92J70-000
		Stainless	3	13 7/8	(352.4)	23	(584.2)	RR		58200-92J80-000
		Stainless	3	13 7/8	(352.4)	25	(635)	RR		58200-92J90-000
		Stainless	3	13 7/8	(352.4)	17	(431.8)	CR		58200-92JA0-000
		Stainless	3	13 7/8	(352.4)	19	(482.6)	CR		58200-92JB0-000
		Stainless	3	13 7/8	(352.4)	21	(533.4)	CR		58200-92JC0-000
		Stainless	3	13 7/8	(352.4)	23	(584.2)	CR		58200-92JD0-000

### HARDWARE FOR PROPELLER

Applicable Model	STOPPER	PROPELLER BUSH	HARDWARE KIT					
			SPACER	WASHER	STOPPER	NUT	COTTER PIN	
DF2.5	57635-91JL0-000	58120-97JA0-000	N/A	-	-	-	58130-91JL0-000	09204-03003-000
DF4A/5A/6A	57635-97L00-000	58120-91JL0-000	N/A	-	-	-	58130-91JL0-000	09204-03003-000
DF8A/9.9A	57632-94J00-000	58120-89L00-000	N/A	-	09160-12066-000	-	09141-12005-000	09204-02004-000
DF9.9B/15A/20A	57632-94J00-000	58120-89L00-000	N/A	-	09160-12066-000	-	09141-12005-000	09204-02004-000
DF25A/30A	57632-91L00-000	58120-96401-000	57630-96300-000	57633-96300-000	09160-14028-000	-	09141-14008-000	09204-03003-000
DF40A/50A/60A	57632-95320-000	58120-88L01-000	57630-94301-000	57633-94301-000	09160-18028-000	-	09141-18005-000	09204-03003-000
DF50AV/60AV	57635-90J01-000	58105-90J00-000	57630-90J00-000	57633-90J02-000	09160-18028-000	-	09141-18005-000	09204-03003-000
DF70A/80A/90A/100B	57632-87L01-000	58105-90J00-000	57630-90J00-000	57633-90J02-000	09160-18028-000	-	09141-18005-000	09204-03003-000
DF100A/115A/115BG/140A/140BG	57635-92J01-000	58105-90J00-000	57630-90J00-000	57633-90J02-000	09160-18028-000	-	09141-18005-000	09204-03003-000
DF150A-300AP	57632-93L11-000	58120-93L00-000	57630-93L00-000	57633-93L00-000	09160-18028-000	-	09141-18005-000	09204-03003-000
DF300B/DF325A/350A Front	58531-98L00-000	58520-98L00-000	58540-98L00-000	58541-98L00-000	-	58551-98L00-000	58561-98L00-000	-
DF300B/DF325A/350A Rear	58631-98L00-000	58620-98L00-000	58640-98L00-000	58641-98L00-000	09160-18019-000	-	09141-18005-000	09204-03003-000

### Choosing The Right Propeller

Propeller selection is very important in the performance of the boat. Acceleration, speed, fuel efficiency, stability and engine RPM all are affected by the propeller. Operating requirements and conditions will also determine which design, style and pitch of the propeller your customer can choose. The combination of boat, engine and appropriate propeller size may have already been tested by the boat manufacturer.

**Your Customer may need your assistance to determine the correct propeller for their application.**

### Stainless Steel Propellers

Suzuki Stainless Steel Propellers offer high performance and durability. Their aggressive design enhances the overall performance of the boat and the durability of stainless steel ensures long term dependability. Suzuki Stainless Steel propellers are also fitted with a rubber cushion hub to help absorb vibration and shock should they strike a foreign object.

### Propeller Sizing

When referring to propeller size, the first number is the number of blades, the second number details the **diameter** of the propeller, and the third number is the **pitch**

Example: **3 x 13 x 18** = 3 blades x Diameter: 13 inches x Pitch: 18 inches.

The pitch is the most significant factor when choosing a propeller.

### Diameter

Diameter is the distance across an imaginary circle that is made when a propeller rotates. Diameter is determined during the the designing process of a propeller and is usually based on engine size, gear case design, horsepower and speed.

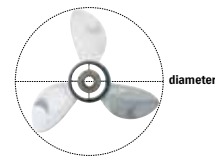

### Pitch

Pitch is the theoretical distance that a propeller corkscrews forward through the water. In theory, an 18" (457.2mm) pitch propeller would travel 18" (457.2mm) with each complete revolution\*.

Lower pitches accelerate faster, but have lower top end speed. Higher pitches have a slower acceleration, but attain higher top speeds. An inch of pitch is generally equal to 150-200 engine RPM at wide open throttle (WOT). If pitch increases by an inch, RPM will decrease by 150-200 RPM at WOT. If pitch decreases by an inch, RPM will increase by 150-200 RPM at WOT.

\*Note during actual operation, this number will be affected by slip factors such as water conditions, boat weight, propeller style, etc.

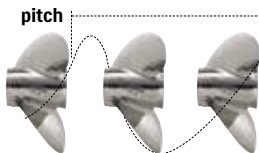

### Propeller Cup

Cup is the curve along the trailing edge of the propeller blade. This reduces propeller slip and ventilation, allowing users to operate their engine at a higher transom mounting, and use more trim for bow lift.

### Rake

Rake is the angle, in degrees, that the propeller blades are mounted to the barrel of the propeller. Blades of a zero degree rake propeller are mounted perpendicular to the barrel. High rake propellers have blades that angle more to the rear of the propeller. These blades hold water longer and ventilate less at higher engine heights.

Such propellers produce higher thrust which helps lift the bow of the boat more effectively.



# CARE & MAINTENANCE ITEM

## SUZUKI MARINE by MOTUL



### 4-STROKE ENGINE OIL

SAE 10W-30 Semi-Synthetic, FC-W

12x1L	99000-22B59-4T1
4x5L	99000-22B59-4T5
60L	99000-22B59-4T6



### 4-STROKE ENGINE OIL

SAE 10W-40 Semi-Synthetic, FC-W

12x1L	99000-22B60-4T1
4x5L	99000-22B60-4T5
60L	99000-22B60-4T6
208L	99000-22B60-4T8



### MARINE GEAR OIL

SAE 90 GL-5

12x1L	99000-22B61-001
-------	-----------------



### MARINE GEAR OIL

SAE 90, GL-5

24x0.35L	99000-22B61-P35
----------	-----------------

## TOUCH-UP PAINT

### 99000-10202-0EP

SHADOW BLACK METALLIC (set)

### 99000-10202-YAY

PEARL NEBULAR BLACK (set)

### 99000-10202-Y5S

COOL WHITE (single)

## PAINT SPRAY



### 990F0-41005-CLR

CLEAR COAT

### 990F0-41005-0ED

CALIFORNIA GREY METALLIC

### 990F0-41005-0EP

SHADOW BLACK METALLIC

### 990F0-41005-YAY

PEARL NEBULAR BLACK

### 990F0-41005-Y5S

COOL WHITE

## LIQUID GASKET



### 99000-31140-THR

1207B (BLACK)  
100 grams (3.5 oz)

## GREASE



### SHELL GADUS S2 V100 3\*

plastic cartridge

For AT, BE, CH, DE, FR, UK, IE, IT, LU, NL, RO  
1 x 400g 990F0-25011-GER

For CZ, DK, EE, FI, UK, HU, LT, LV, NO, PL, SE, SK  
1 x 400g 990F0-25011-002

For BA, BG, ES, HR, IT, PT, RO, RS, SI, TR  
1 x 400g 990F0-25011-003

\*Replacement for Super Grease A  
99000-25011-000/99000-25480-000



### 99000-25350-000

WATER RESISTANT GREASE EP2  
250 grams (8.8 oz)

## THREAD LOCK



### 99000-32130-000

1360 (RED)  
50 grams (1.7 oz)

## FLUSH-HOSE ATTACHMENT



**55181-95200-000**

Applicable Model DF4A-6A/40A-60A



**17917-87L00-000**

Applicable Model DF8A-350A

## FLUSHING TOOLHMENT



**99000-81202-000**

FLUSHING TOOL

Applicable Model DF325A/350A

## BATTERY CHARGER



**990E0-OPTIM-CAR**

OptiMate 6, versatile battery charger, maintainer and tester. Recommended for STS/AGM/MF/GEL and spiral cell batteries from 15 Ah to 240 Ah.

## ZINC ANODE for saltwater



**55300-95500-000**

Applicable Model DF8A/9.9A/40A-60A



**55125-96310-000**

Applicable Model DF25/R/Q



**55321-90J01-000**

Applicable Model DF50AV/60AV/100A-140A

## ALUMINUM ANODE for brackish water, saltwater



**55321-87J01-000**

Applicable Model DF2.5-350A



**55320-94900-000**

Applicable Model DF60A-350A



**55321-95J00-000**

Applicable Model DF2.5,DF4A-6A

**55321-93J01-000**

Applicable Model DF70A-90A/100B/150-350A

## MAGNESIUM ANODE for freshwater



**55321-87J11-000**

Applicable Model DF4A-350A



**55321-94910-000**

Applicable Model DF70A-350A

## Anode Bulk Pack

**55321-87810-B50**

Applicable Model DF2.5-300AP

50pcs in one package

## ENGINE COVER



**99000-81700-000**

Applicable Model DF8A-20A

**99000-81730-000**

Applicable Model DF115BG/140BG, DF200T/Z-250T/Z

**99000-81710-000**

Applicable Model DF25A-60A

**99000-81740-000**

Applicable Model DF150A-200A/175AP/200AP/250AP/300AP

**99000-81720-000**

Applicable Model DF70A-140A

**99000-81750-000**

Applicable Model DF300B/325A/350A

# MAINTENANCE KIT



SUZUKI highly recommends you to replace your outboard motor with Maintenance Kits every 100 hours or 1 year, whichever comes first.



## ALL LINEUP For 4 STROKE OBM

MODEL YEAR	KIT PART NUMBER	PART NUMBER	PART NAME	QTY
DF2/2.5 ('06-'11)	17400-97820	09168-10022-000	GASKET(10X17X1.5)	1
		09202-02006-000	PIN(2.9X14)	1
		09204-03003-000	PIN	1
		09280-33005-000	O RING(D:1.9,ID:32.7)	1
		09482-00406-000	PLUG,SPARK(CR6HSA)	1
		17461-97J00-000	IMPELLER,WATER PUMP	1
		17471-97J00-000	PANEL,PUMP CASE UNDER	1
		17472-97J00-000	GASKET,PUMP CASE PANEL	1
		55321-87J01-000	ANODE,PROTECTION	1
DF2/2.5 ('12-)	17400-97810	59178-97J00-000	GASKET,DRAIN PLUG	2
		09168-10022-000	GASKET(10X17X1.5)	1
		09202-02006-000	PIN(2.9X14)	1
		09204-03003-000	PIN	1
		09280-33005-000	O RING(D:1.9,ID:32.7)	1
		09482-00406-000	PLUG,SPARK(CR6HSA)	1
		17461-97J00-000	IMPELLER,WATER PUMP	1
		17471-97J00-000	PANEL,PUMP CASE UNDER	1
		17472-97J00-000	GASKET,PUMP CASE PANEL	1
		55321-87J01-000	ANODE,PROTECTION	1
59178-97J00-000	GASKET,DRAIN PLUG	2		

MODEL YEAR	KIT PART NUMBER	PART NUMBER	PART NAME	QTY		
DF4/5/6 ('02-'10)	17400-91860	17400-98661-000	KIT, WATER PUMP REPAIR	1		
		09168-10022-000	GASKET(10X17X1.5)	3		
		09204-03003-000	PIN	1		
		09482-00299-000	PLUG,SPARK(BPR6ES)	1		
		15410-98500-000	FILTER,FUEL	1		
		17412-91J00-000	PANEL,WATER PUMP CASE UP	1		
		17413-91J00-000	SLEEVE,WATER PUMP CASE	1		
DF4/5/6 ('11-'16)	17400-91830	55321-87J01-000	ANODE,PROTECTION	2		
		17400-98661-000	KIT, WATER PUMP REPAIR	1		
		09168-10022-000	GASKET(10X17X1.5)	3		
		09204-03003-000	PIN	1		
		09482-00L04-000	PLUG,SPARK(CPR6EA-9)	1		
		15410-98500-000	FILTER,FUEL	1		
		17412-91J00-000	PANEL,WATER PUMP CASE UP	1		
DF4A/5A/6A P01 DF4A/6A P03 ('17-)	17400-91891	17413-91J00-000	SLEEVE,WATER PUMP CASE	1		
		44330-13H00-000	FILTER,FUEL	1		
		55321-87J01-000	ANODE,PROTECTION	1		
		55321-95J00-000	ANODE,PROTECTION	1		
		59178-97J00-000	GASKET,DRAIN PLUG	2		
		17400-98661-000	KIT, WATER PUMP REPAIR	1		
		09168-12017-000	GASKET(12X17X1)	1		
		09204-03003-000	PIN	1		
		09280-39002-000	O RING(D:2,ID:38.5)	1		
		09482-00L04-000	PLUG,SPARK(CPR6EA-9)	1		
		16510-16H11-000	FILTER,ENGINE OIL	1		
		17412-91J00-000	PANEL,WATER PUMP CASE UP	1		
		17413-91J00-000	SLEEVE,WATER PUMP CASE	1		
DF8A/9.9A ('10-)	17400-99840	17400-99J01-000	KIT,WATER PUMP REPAIR	1		
		09168-12017-000	GASKET(12X17X1)	1		
		09204-02004-000	PIN	1		
		09280-13004-000	O RING(D:1.9,ID:13)	1		
		09280-22019-000	O RING(D:1.9,ID:21.8)	1		
		09280-54001-000	O RING(D:2.4,ID:52.6)	1		
		09482-00528-000	PLUG,SPARK(CR6E)	2		
		15410-98500-000	FILTER,FUEL	1		
		16510-45H10-000	FILTER ASSY,ENG OIL	1		
		17413-94J00-000	SLEEVE,WATER PUMP CASE	1		
		55321-87J01-000	ANODE,PROTECTION	2		
		59178-97J00-000	GASKET,DRAIN PLUG	2		
		DF9.9/15 ('11-'13)	17400-94810	17400-94J00-000	KIT, WATER PUMP REPAIR	1
09168-10022-000	GASKET(10X17X1.5)			2		
09168-12017-000	GASKET(12X17X1)			1		
09204-02004-000	PIN			1		
09280-10013-000	O RING(D:2.4,ID:9.6)			1		
09482-00L04-000	PLUG,SPARK(CPR6EA-9)			2		
15410-98500-000	FILTER,FUEL			1		
16510-45H10-000	FILTER ASSY,ENG OIL			1		
17413-94J00-000	SLEEVE,WATER PUMP CASE			1		
55321-90L00-000	ZINC,PROTECTION			1		
55321-99E00-000	ANODE,PROTECTION			1		
DF9.9B/15A/20A ('13-)	17400-89811			17400-99J01-000	KIT, WATER PUMP REPAIR	1
				09168-12017-000	GASKET(12X17X1)	1
		09204-02004-000	PIN	1		
		09280-13004-000	O RING(D:1.9,ID:13)	1		
		09280-22019-000	O RING(D:1.9,ID:21.8)	1		
		09280-54001-000	O RING(D:2.4,ID:52.6)	1		
		09482-00661-000	PLUG,SPARK(MR6K-9)	2		
		15410-87L00-000	FILTER,FUEL	1		
		16510-45H10-000	FILTER ASSY,ENG OIL	1		
		17413-94J00-000	SLEEVE,WATER PUMP CASE	1		
		55321-87J01-000	ANODE,PROTECTION	2		
		59178-97J00-000	GASKET,DRAIN PLUG	2		
		DF20/25 V2 ('06-)	17400-95872	17400-95J03-000	KIT, WATER PUMP REPAIR	1
09168-10022-000	GASKET(10X17X1.5)			2		
09168-12012-000	GASKET(12.5X20X2.5)			1		
09204-03003-000	PIN			1		
09280-10013-000	O RING(D:2.4,ID:9.6)			2		
09280-22019-000	O RING(D:1.9,ID:21.8)			1		
09482-00427-000	PLUG,SPARK(NGK,BKR6E)			2		
15410-87J30-000	FILTER,FUEL			1		
16510-87J01-000	FILTER ASSY,OIL			1		
17413-95J00-000	SLEEVE,WATER PUMP CASE			1		
55321-87J01-000	ANODE,PROTECTION			5		
55321-95J00-000	ANODE,PROTECTION			2		
DF25/30 ('01-'10)	17400-89822			17400-96354-000	KIT, WATER PUMP REPAIR	1
		09168-10022-000	GASKET(10X17X1.5)	2		
		09168-12012-000	GASKET(12.5X20X2.5)	1		
		09204-03003-000	PIN	1		
		09482-00446-000	PLUG,SPARK(NGK DCPR6E)	3		
		11265-87E10-000	GASKET,PROTECTION COVER	1		
		15410-87J10-000	FILTER,FUEL	1		
		16510-87J01-000	FILTER ASSY,OIL	1		
		55321-87J01-000	ANODE,PROTECTION	1		

MODEL YEAR	KIT PART NUMBER	PART NUMBER	PART NAME	QTY
DF25A/30A ('15-)	17400-94824	17400-94L21-000	KIT, WATER PUMP REPAIR	1
		09168-12017-000	GASKET(12X17X1)	1
		09204-03003-000	PIN	1
		09280-22019-000	O RING(D:1.9,ID:21.8)	1
		09482-00661-000	PLUG,SPARK(MRGK-9)	3
		15410-87L00-000	FILTER,FUEL	1
		16510-87J01-000	FILTER ASSY,OIL	1
		17413-94L00-000	SLEEVE,WATER PUMP CASE	1
		55321-87J01-000	ANODE,PROTECTION	5
59178-97J00-000	GASKET,DRAIN PLUG	2		
DF40/50 ('06LATE-'10)	17400-87822	17400-96354-000	KIT, WATER PUMP REPAIR	1
		09168-10022-000	GASKET(10X17X1.5)	2
		09168-12012-000	GASKET(12.5X20X2.5)	1
		09204-03003-000	PIN	1
		09280-22019-000	O RING(D:1.9,ID:21.8)	2
		09482-00446-000	PLUG,SPARK(NGK DCPR6E)	3
		15410-87J30-000	FILTER,FUEL	1
		16510-87J01-000	FILTER ASSY,OIL	1
		55321-87J01-000	ANODE,PROTECTION	2
DF40A/50A/60A ('10-)	17400-88812	17400-88L01-000	KIT, WATER PUMP REPAIR	1
		09168-10022-000	GASKET(10X17X1.5)	2
		09168-12012-000	GASKET(12.5X20X2.5)	1
		09204-03003-000	PIN	1
		09280-22019-000	O RING(D:1.9,ID:21.8)	2
		09482-00446-000	PLUG,SPARK(NGK DCPR6E)	3
		15410-88L00-000	FILTER,FUEL	1
		16510-87J01-000	FILTER ASSY,OIL	1
		55321-87J01-000	ANODE,PROTECTION	3
DF50A/60A ('14-)	17400-88822	17400-99E12-000	KIT, WATER PUMP REPAIR	1
		09168-10022-000	GASKET(10X17X1.5)	2
		09168-12012-000	GASKET(12.5X20X2.5)	1
		09204-03003-000	PIN	1
		09280-22019-000	O RING(D:1.9,ID:21.8)	2
		09482-00446-000	PLUG,SPARK(NGK DCPR6E)	3
		15410-88L00-000	FILTER,FUEL	1
		16510-87J01-000	FILTER ASSY,OIL	1
		55321-87J01-000	ANODE,PROTECTION	3
DF60 ('09LATE-'09END)	17400-99852	17400-99E12-000	KIT, WATER PUMP REPAIR	1
		09168-10022-000	GASKET(10X17X1.5)	2
		09168-12012-000	GASKET(12.5X20X2.5)	1
		09204-03003-000	PIN	1
		09482-00299-000	PLUG,SPARK(BPR6ES)	4
		11265-87E10-000	GASKET,PROTECTION COVER	1
		15410-87J30-000	FILTER,FUEL	1
		16510-87J01-000	FILTER ASSY,OIL	1
		55321-87J01-000	ANODE,PROTECTION	1
DF60/70 ('07)	17400-99871	17400-87E04-000	KIT, WATER PUMP REPAIR	1
		09168-10022-000	GASKET(10X17X1.5)	2
		09168-12012-000	GASKET(12.5X20X2.5)	1
		09204-03003-000	PIN	1
		09482-00299-000	PLUG,SPARK(BPR6ES)	4
		11265-87E10-000	GASKET,PROTECTION COVER	1
		15410-87J30-000	FILTER,FUEL	1
		16510-87J01-000	FILTER ASSY,OIL	1
		55321-87J01-000	ANODE,PROTECTION	1
DF60/70 ('08-'09EARLY)	17400-99861	17400-99E01-000	KIT, WATER PUMP REPAIR	1
		09168-10022-000	GASKET(10X17X1.5)	2
		09168-12012-000	GASKET(12.5X20X2.5)	1
		09204-03003-000	PIN	1
		09482-00299-000	PLUG,SPARK(BPR6ES)	4
		11265-87E10-000	GASKET,PROTECTION COVER	1
		15410-87J30-000	FILTER,FUEL	1
		16510-87J01-000	FILTER ASSY,OIL	1
		17413-99E11-000	SLEEVE,WATER PUMP CASE	1
17416-99E00-000	SEALING,WATER PUMP CASE NO.1	1		
17417-99E00-000	SEALING,WATER PUMP CASE NO.2	1		
55321-87J01-000	ANODE,PROTECTION	1		
DF70A/80A/90A ('09-)	17400-87811	17400-87L04-000	KIT, WATER PUMP REPAIR	1
		09168-10034-000	GASKET(9.5X16.5X2)	2
		09168-12012-000	GASKET(12.5X20X2.5)	1
		09204-03003-000	PIN	1
		09280-22019-000	O RING(D:1.9,ID:21.8)	3
		09482-00446-000	PLUG,SPARK(NGK DCPR6E)	4
		15410-87L00-000	FILTER,FUEL	1
		16510-61A31-000	FILTER ASSY,OIL WAKO	1
		55321-87J01-000	ANODE,PROTECTION	3
DF100/115 ('10-'12)	17400-92841	17400-92J23-000	KIT, WATER PUMP REPAIR	1
		09168-10022-000	GASKET(10X17X1.5)	2
		09168-12012-000	GASKET(12.5X20X2.5)	1
		09204-03003-000	PIN	1
		09280-22019-000	O RING(D:1.9,ID:21.8)	2
		09482-00427-000	PLUG,SPARK(NGK,BKR6E)	4
		11265-87E10-000	GASKET,PROTECTION COVER	2
		15410-87J30-000	FILTER,FUEL	1
		16510-61A31-000	FILTER ASSY,OIL WAKO	1
55321-87J01-000	ANODE,PROTECTION	4		

MODEL YEAR	KIT PART NUMBER	PART NUMBER	PART NAME	QTY
DF100B ('18-)	17400-87831	17400-87L04-000	KIT, WATER PUMP REPAIR	1
		09168-10034-000	GASKET(9.5X16.5X2)	2
		09168-12012-000	GASKET(12.5X20X2.5)	1
		09204-03003-000	PIN	1
		09280-22019-000	O RING(D:1.9,ID:21.8)	3
		09482-00446-000	PLUG,SPARK(NGK DCPR6E)	4
		15412-92J00-000	FILTER,FUEL	1
		16510-61A31-000	FILTER ASSY,OIL WAKO	1
		55321-87J01-000	ANODE,PROTECTION	3
DF100A/115A/140A ('13-)	17400-92822	17400-92J23-000	KIT, WATER PUMP REPAIR	1
		09168-10022-000	GASKET(10X17X1.5)	2
		09168-12012-000	GASKET(12.5X20X2.5)	1
		09204-03003-000	PIN	1
		09280-22019-000	O RING(D:1.9,ID:21.8)	2
		09482-00427-000	PLUG,SPARK(NGK,BKR6E)	4
		11265-87E10-000	GASKET,PROTECTION COVER	2
		15412-92J00-000	FILTER,FUEL	1
		16510-61A31-000	FILTER ASSY,OIL WAKO	1
55321-87J01-000	ANODE,PROTECTION	4		
DF140 ('10-'12)	17400-92851	17400-92J23-000	KIT, WATER PUMP REPAIR	1
		09168-10022-000	GASKET(10X17X1.5)	2
		09168-12012-000	GASKET(12.5X20X2.5)	1
		09204-03003-000	PIN	1
		09280-22019-000	O RING(D:1.9,ID:21.8)	2
		09280-56005-000	O RING(D:3.5,ID:56.74)	1
		09280-60007-000	O RING(D:3.5,ID:59.6)	1
		09280-70002-000	O RING(D:3.1,ID:69.4)	1
		09482-00427-000	PLUG,SPARK(NGK,BKR6E)	4
11265-87E10-000	GASKET,PROTECTION COVER	2		
15410-87J30-000	FILTER,FUEL	1		
16510-92J00-000	FILTER ASSY,OIL	1		
16621-73G00-000	GASKET,OIL COOLER	1		
55321-87J01-000	ANODE,PROTECTION	4		
DF150/175 ('06-)	17400-96823	17400-96J04-000	KIT, WATER PUMP REPAIR	1
		09168-10034-000	GASKET(9.5X16.5X2)	2
		09168-12012-000	GASKET(12.5X20X2.5)	1
		09204-03003-000	PIN	1
		09280-22019-000	O RING(D:1.9,ID:21.8)	4
		09482-00427-000	PLUG,SPARK(NGK,BKR6E)	5
		15410-96J00-000	FILTER,FUEL	1
		16510-96J10-000	FILTER ASSY,OIL	1
		55321-87J01-000	ANODE,PROTECTION	6
DF200A/200AP/175AP/150AP ('16-)	17400-96832	17400-96J04-000	KIT, WATER PUMP REPAIR	1
		09168-10034-000	GASKET(9.5X16.5X2)	2
		09168-12012-000	GASKET(12.5X20X2.5)	1
		09204-03003-000	PIN	1
		09280-22019-000	O RING(D:1.9,ID:21.8)	5
		09482-00649-000	PLUG,SPARK(LKR6E)	4
		15412-92J00-000	FILTER,FUEL	1
		16510-96J10-000	FILTER ASSY,OIL	1
		55321-87J01-000	ANODE,PROTECTION	6
DF200/225/250 ('11-)	17400-93853	17400-93J04-000	KIT, WATER PUMP REPAIR	1
		09168-10034-000	GASKET(9.5X16.5X2)	2
		09168-12012-000	GASKET(12.5X20X2.5)	1
		09204-03003-000	PIN	1
		09280-22019-000	O RING(D:1.9,ID:21.8)	7
		09482-00427-000	PLUG,SPARK(NGK,BKR6E)	6
		15412-93J10-000	FILTER ASSY,FUEL	1
		16510-96J10-000	FILTER ASSY,OIL	1
		55320-94900-000	ANODE SET,CLAMP BRACKET	1
55321-87J01-000	ANODE,PROTECTION	7		
DF250A/300A/250S ('11-)	17400-98863	17400-98J03-000	KIT, WATER PUMP REPAIR	1
		09168-10034-000	GASKET(9.5X16.5X2)	2
		09168-12012-000	GASKET(12.5X20X2.5)	1
		09204-03003-000	PIN	1
		09280-22019-000	O RING(D:1.9,ID:21.8)	7
		09482-00427-000	PLUG,SPARK(NGK,BKR6E)	6
		15412-93J10-000	FILTER ASSY,FUEL	1
		16510-96J10-000	FILTER ASSY,OIL	1
		55320-94900-000	ANODE SET,CLAMP BRACKET	1
55321-87J01-000	ANODE,PROTECTION	8		
DF325A/350A ('18-)	17400-98871	17400-98L02-000	KIT, WATER PUMP REPAIR	1
		09168-10034-000	GASKET(9.5X16.5X2)	3
		09168-12012-000	GASKET(12.5X20X2.5)	1
		09204-03003-000	PIN	1
		09280-22019-000	O RING(D:1.9,ID:21.8)	7
		09482-00642-000	PLUG,SPARK(NGK,ILZKR7D8)	6
		15412-93J10-000	FILTER ASSY,FUEL	1
		16510-96J10-000	FILTER ASSY,OIL	1
		55320-94900-000	ANODE SET,CLAMP BRACKET	1
55321-87J01-000	ANODE,PROTECTION	7		

# THE ULTIMATE OUTBOARD MOTOR



Please read your Owner's Manual carefully. Remember, boating and alcohol or other drugs don't mix. Always wear a personal flotation device when boating. Please operate your outboard safely and responsibly.

Suzuki encourages you to operate your boat safely and with respect for the marine environment.

Specifications, appearances, equipment, colors, materials and other items of "SUZUKI" products shown in this catalog are subject to change by manufacturers at any time without notice and they may vary depending on local conditions or requirements. Some models are not available in some territories. Each model might be discontinued without notice. Please enquire at your local dealer for details of any such changes. Actual body color might differ from the colors in this brochure.



300 TAKATSUKA-CHO, MINAMI-KU, HAMAMATSU-SHI, SHIZUOKA 432-8611 JAPAN  
[www.globalsuzuki.com](http://www.globalsuzuki.com)

2022 SUZUKI GENUINE MARINE P & A For EU